

- EN/AS Impact Area 111.5 m²
- ==== Falling Space 112 m²
Max Falling Height 2440 mm

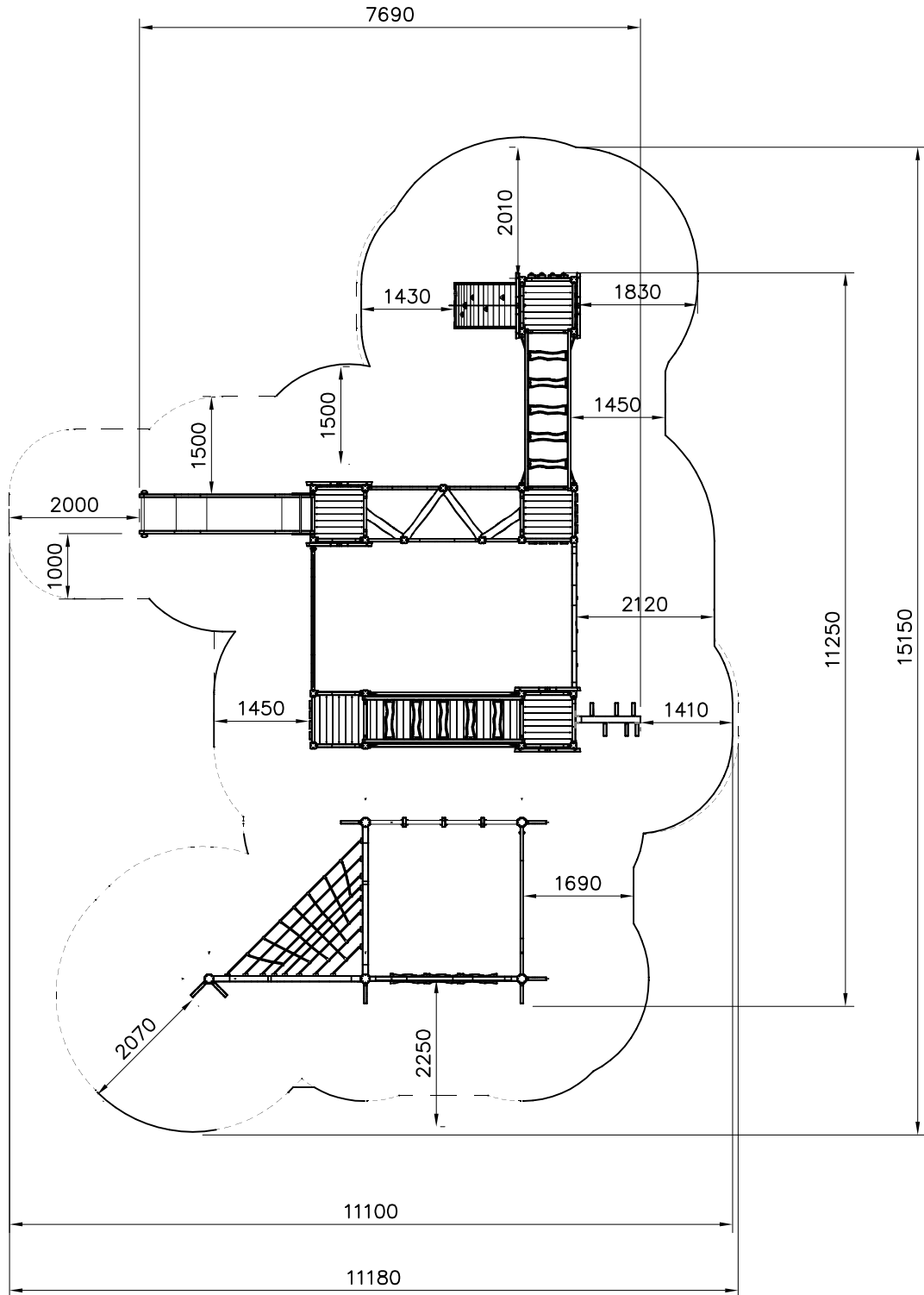

DATE: 17.9.2024

702286 65x65	PCS 1	705197-614 45x145x724	PCS 6	705203-614 93x93x3138	PCS 3	705211-614 45x145x724	PCS 15	705214-614 45x145x724	PCS 9	705217-614 93x93x2250	PCS 7
705220-614 93x93x2446	PCS 6	705230-614 93x93x3138	PCS 5	705236-614 93x93x3138	PCS 6	705238-614 93x93x2846	PCS 6	705247-614 93x93x2846	PCS 1	705258-614 93x93x2846	PCS 5
705262-614 93x93x2846	PCS 2	705270-614 93x93x2846	PCS 1	705308-614 93x93x2846	PCS 1	705368-614 93x93x2846	PCS 1	705375-614 93x93x2846	PCS 1	705429-614 140x140x2894	PCS 5
705431-614 68x260x2280	PCS 2	705506-614 93x93x2846	PCS 2	705507-614 93x93x2846	PCS 5	705511 93x93x2846	PCS 8	705804-614 45x145x2280	PCS 2	705917-614 93x93x2846	PCS 1
705927 93x93x2846	PCS 1	705932-614 93x93x2846	PCS 1	705951-614 93x93x2846	PCS 1	708558-614 93x93x2846	PCS 1	711514-614 93x93x2846	PCS 12	711863 93x93x2846	PCS 2
903093 Ø8x90	PCS 122	903112 l=750	PCS 5	905104 M10	PCS 152	905838-216 L 1060	PCS 12	909256 Ø16/8.4	PCS 96	909521 Ø7x60	PCS 28
980114 Ø4x20	PCS 4	980123 Ø7x60	PCS 96		PCS		PCS		PCS		PCS

