

① 706056	PCS	② 704946	PCS
	1		2
		120x120x1350	
③ 705585	PCS	④ 980114	PCS
	2		4
1284x298x19		Ø4x20	
⑤ 905104	PCS	⑥ 905761	PCS
	8		2
M10		120x120x700	
⑦ 905830	PCS	⑧ 905838	PCS
	2		1
123x123x40		1060 Lime	
⑨ 906613	PCS	⑩ 909256	PCS
	1		56
1060x490x161		Ø16/8.4x1.6	
⑪ 909873	PCS	⑫ 980104	PCS
	16		2
M8x40		Ø5x90	
⑬ 980123	PCS	⑭ 980160	PCS
	24		16
Ø7x60		M8	
	PCS		PCS

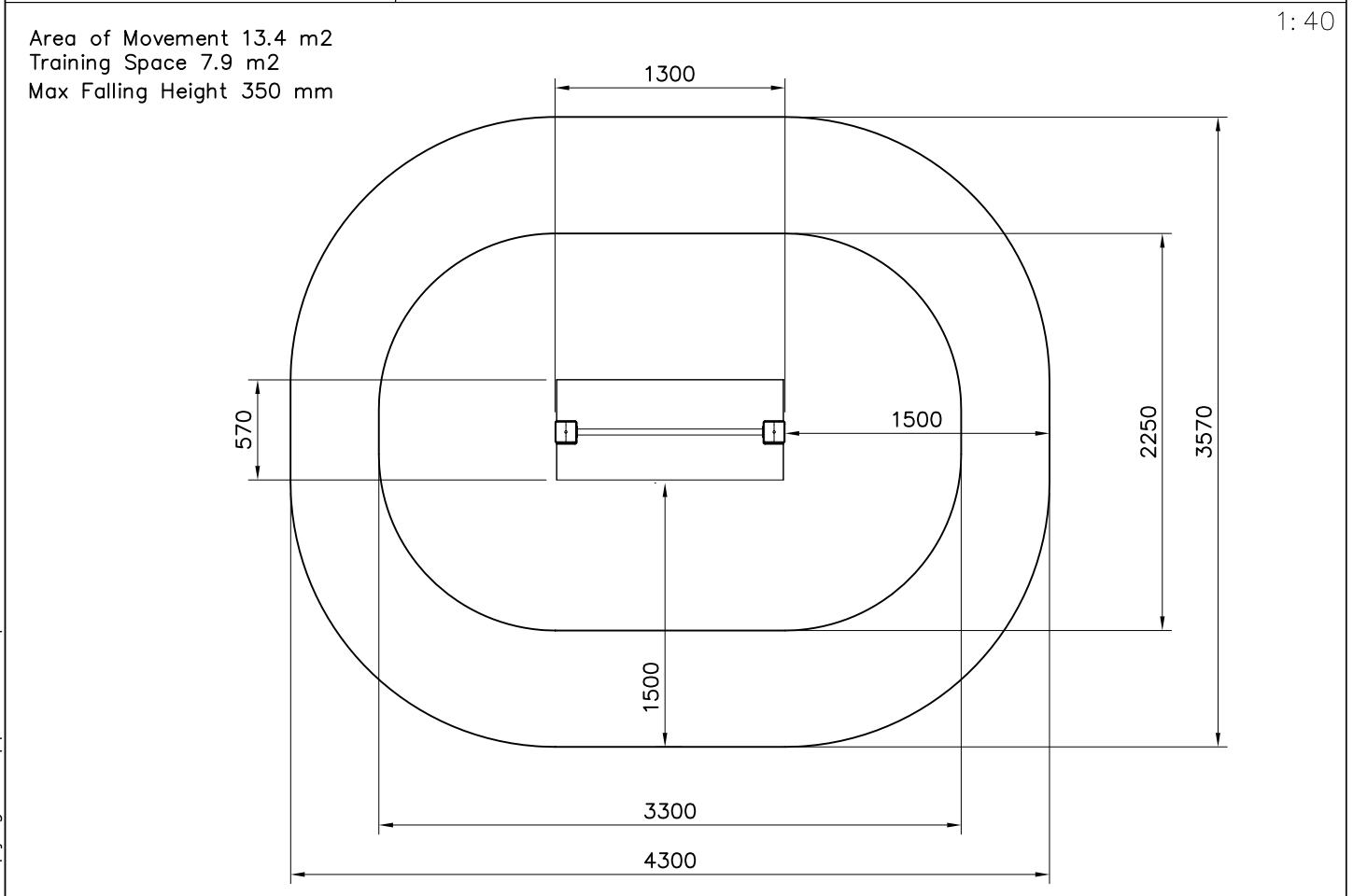

		
<p>$h < 600$</p> <p>Without movement and therefore without Impact Area</p>	<p>Totally hard surfaces.</p> <p>Note. Lappset does <u>not recommend</u> totally hard surfaces at all.</p>	<p>E.g. concrete or asphalt</p> 
<p>$h < 600$</p> <p>With movement e.g. rocking</p>	<p>Materials with very limited impact attenuating properties.</p>	<p>E.g. wood</p> 
<p>$h < 1000$</p>	<p>Materials with significant impact attenuating properties.</p>	<p>fine gravel 0–8 mm</p>  <p>grass</p>  <p>unsorted sand</p> 
<p>$h < 3000$</p>	<p>Loose fill material</p> <p>E.g. sand/gravel 0,25...8 mm D60/D10<3,0 Woodchips 5...30 mm bark 20...80 mm</p>	 <p>\underline{S} \underline{h}</p> <p>30 cm < 2,0 m</p> <p>40 cm < 3,0 m</p>
	<p>Syntethic granulates</p> <p>\underline{S} \underline{h}</p> <p>40 mm ~> 1,2...1,3 m</p> <p>50 mm ~> 1,5...1,7 m</p> <p>60 mm ~> 1,8...2,0 m</p> <p>70 mm ~> 2,1...2,5 m</p> <p>Note. For accurate values, see manufacturer's instructions.</p>	

REMOVE SAFETY SURFACE/SAND/GRAVEL
TO CHECK FOUNDATION

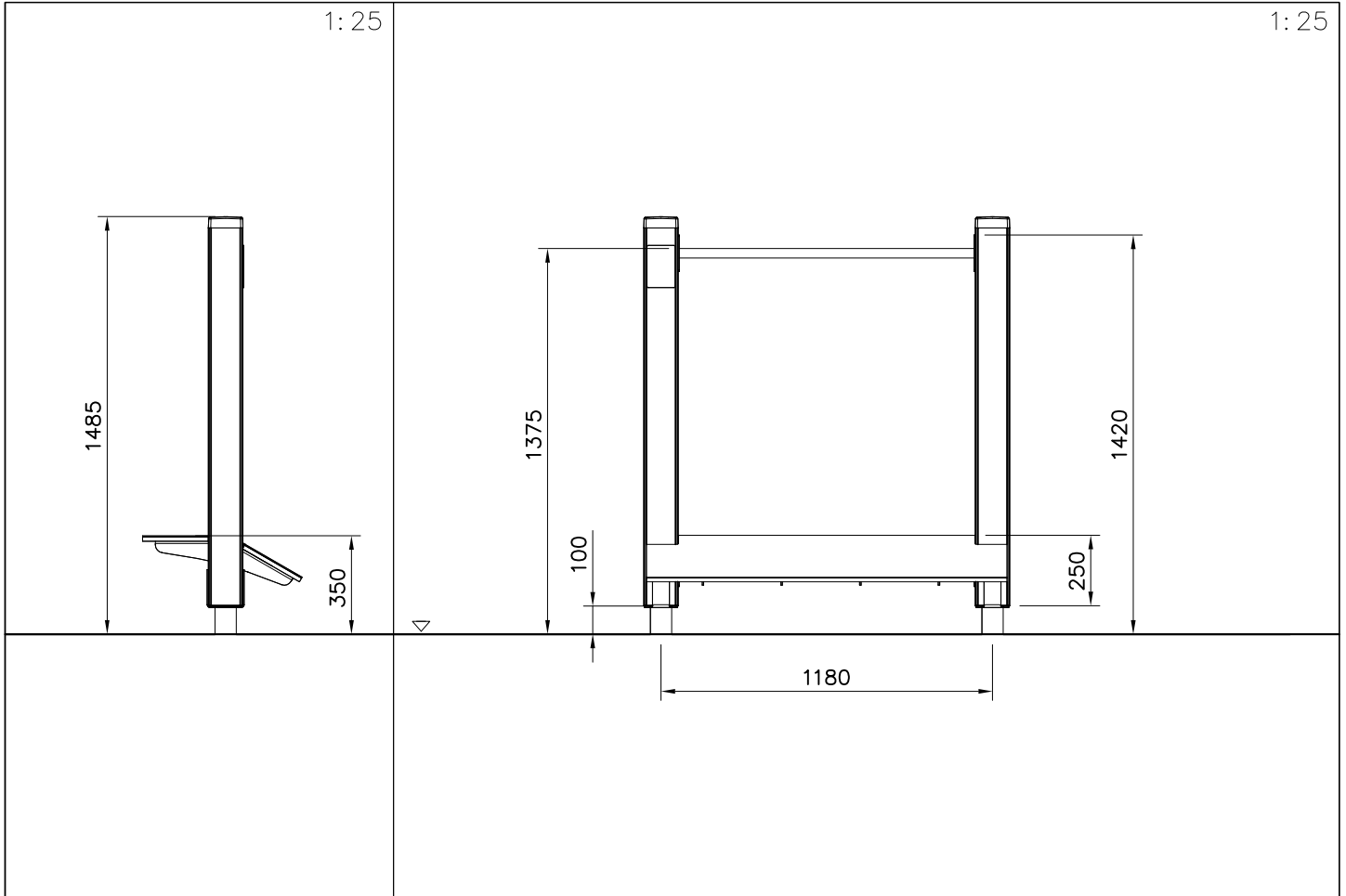

REMOVE SAFETY SURFACE/SAND/GRAVEL
TO CHECK FOUNDATION



DET 1

$\varnothing 16 \downarrow > 130$

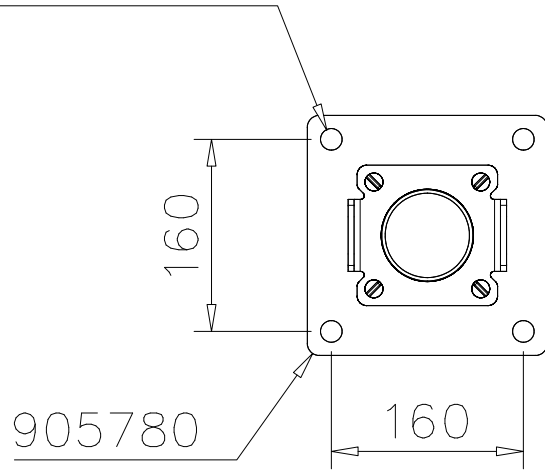

DET 2

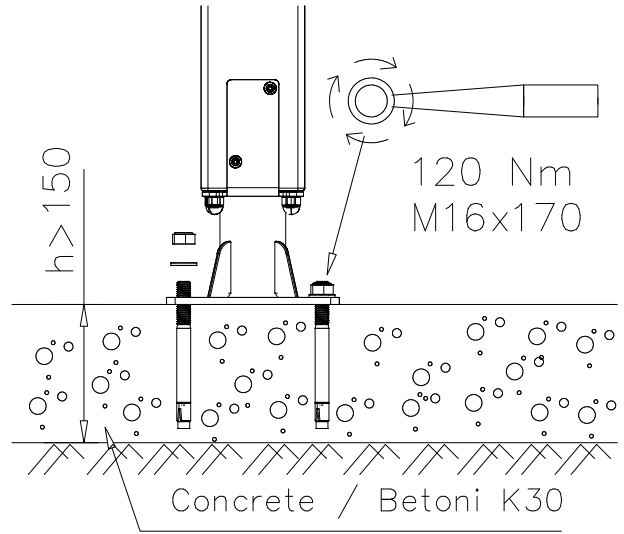

DET 3

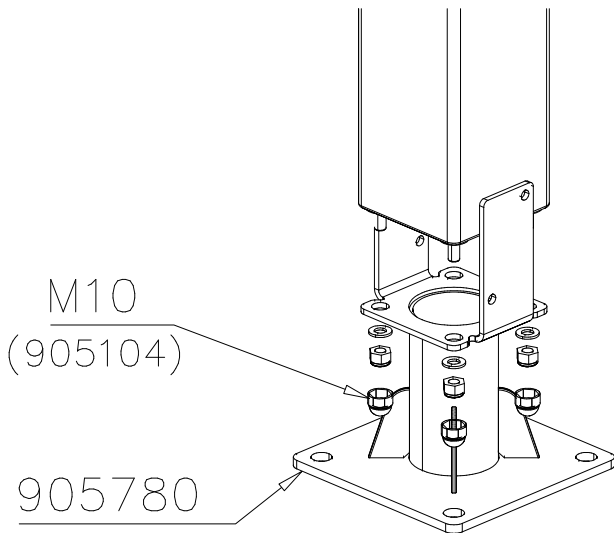

DET 4

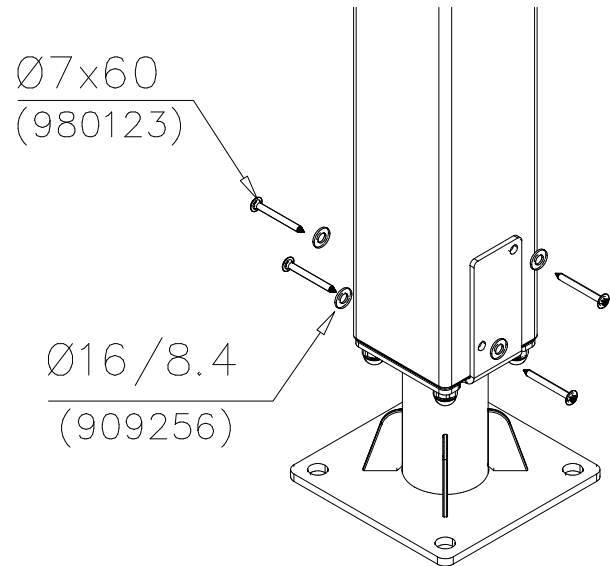

DET 5

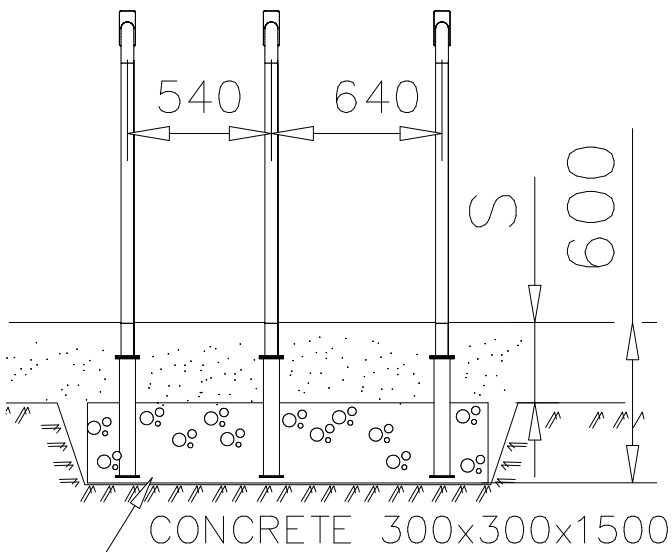

DET 6

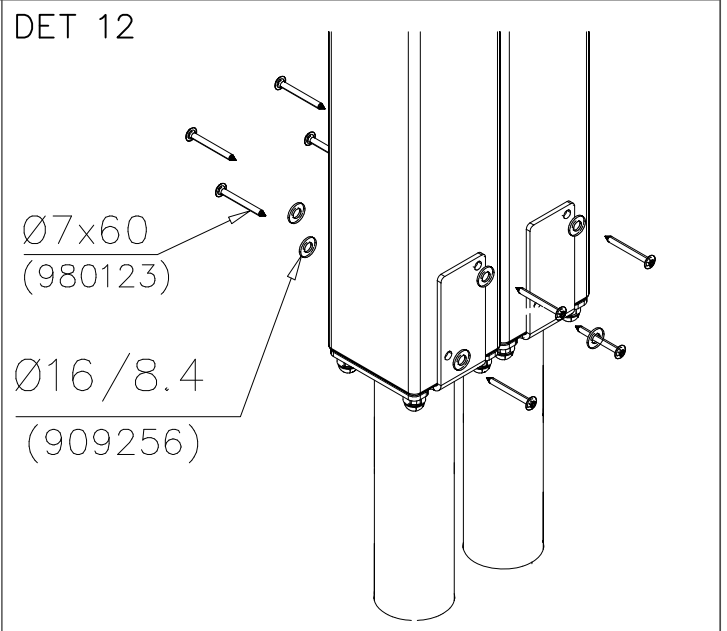
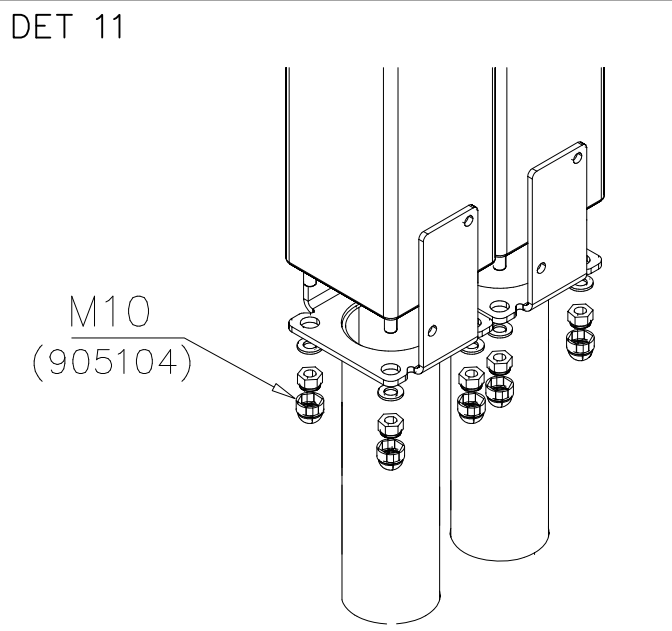
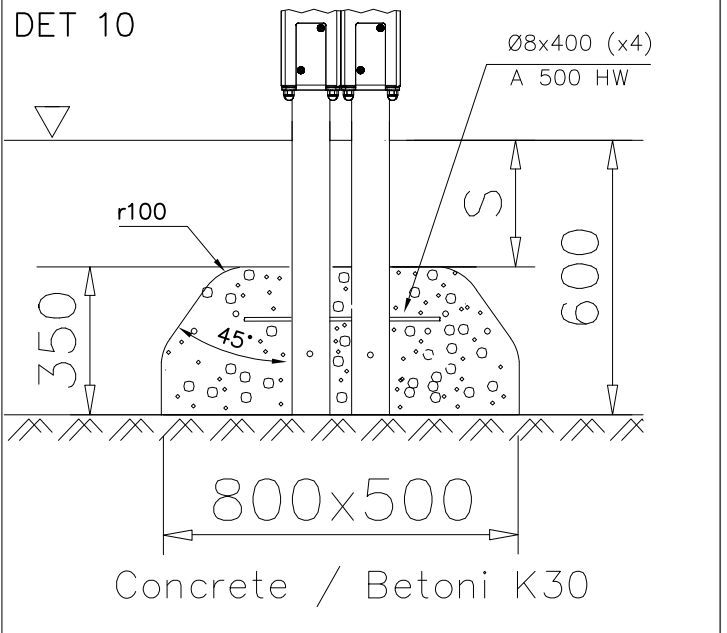
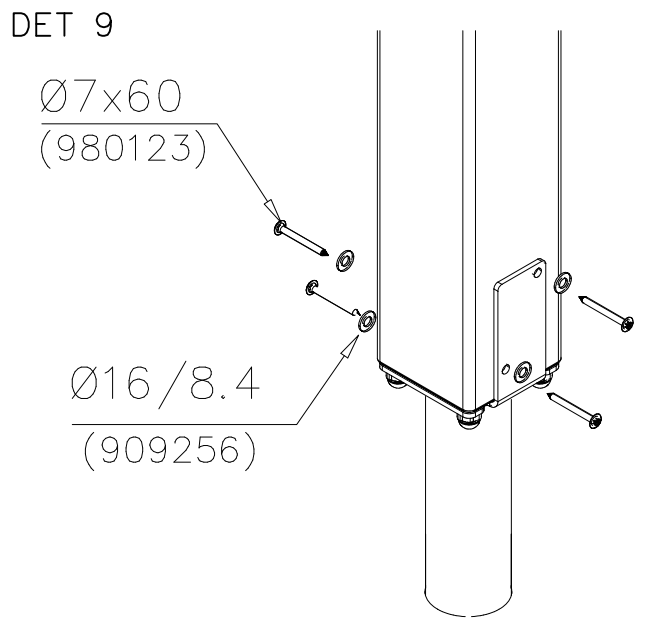
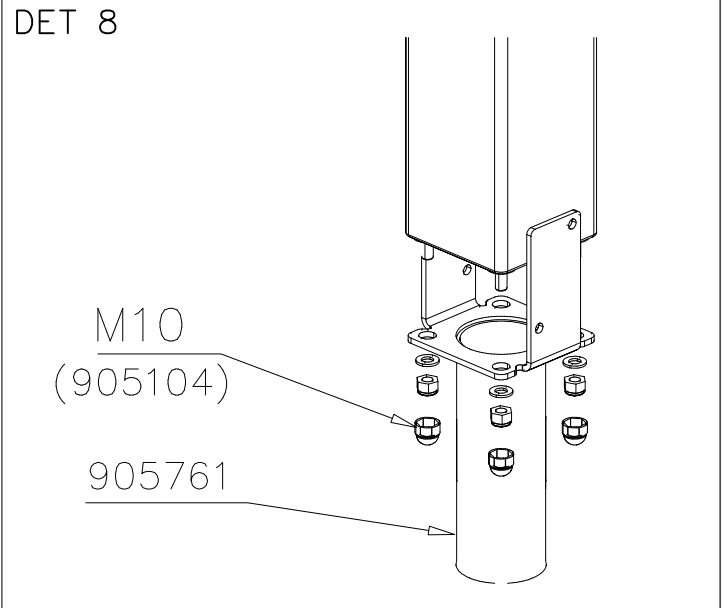
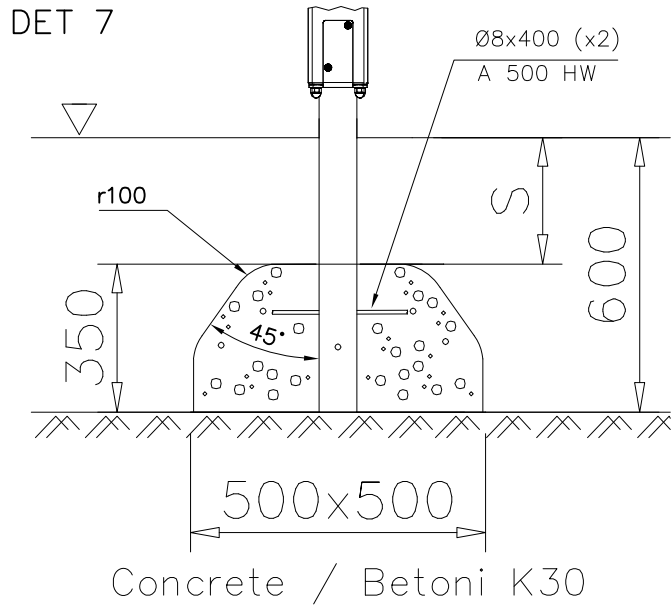

DET 13

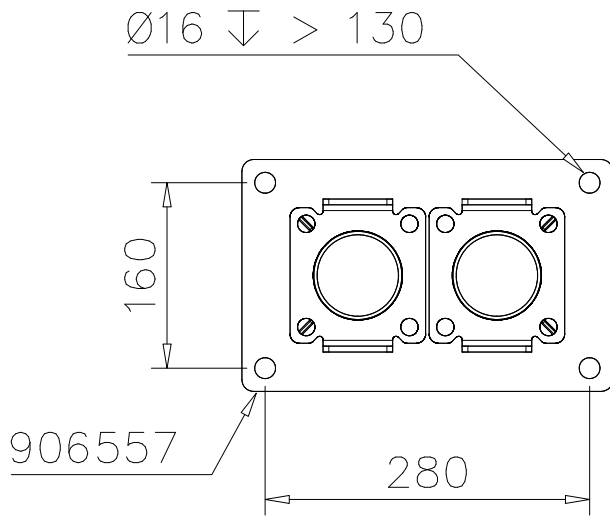

DET 14

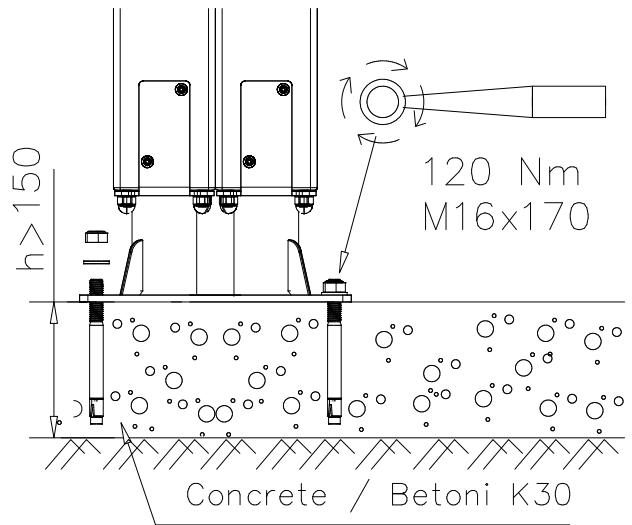

DET 15

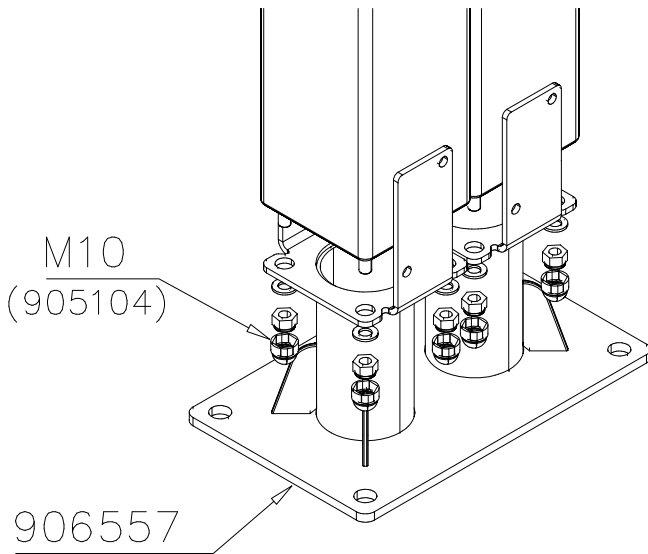

DET 16

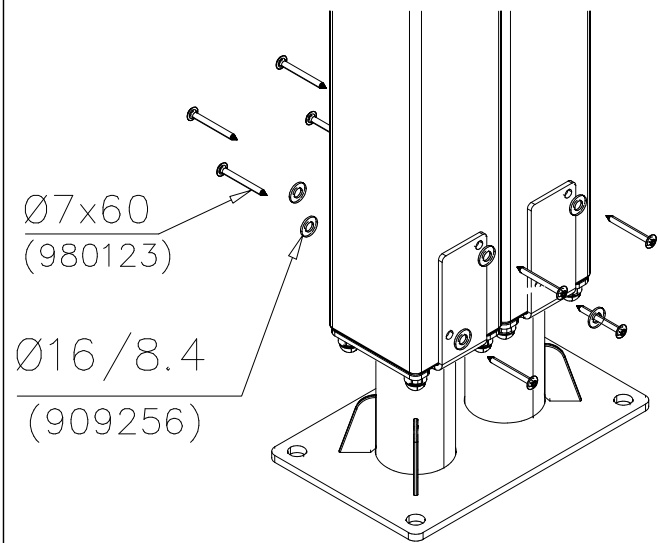

DET 17

DET 18

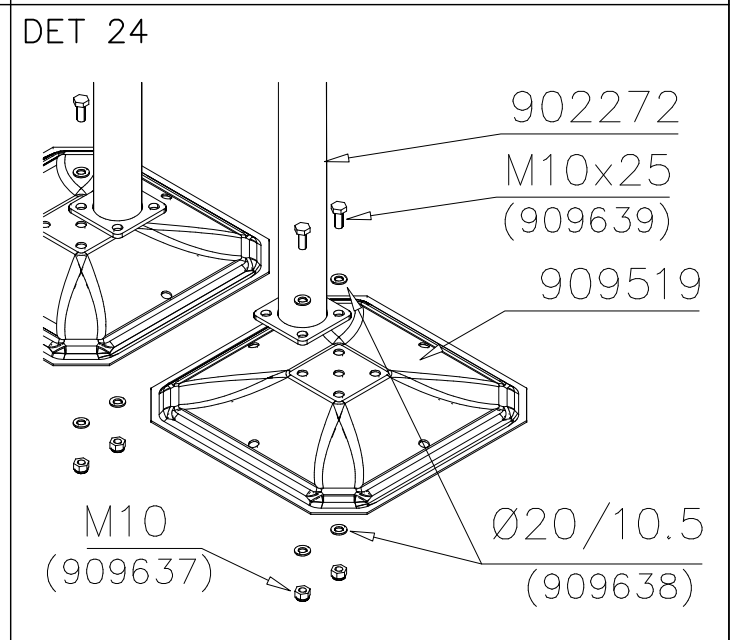
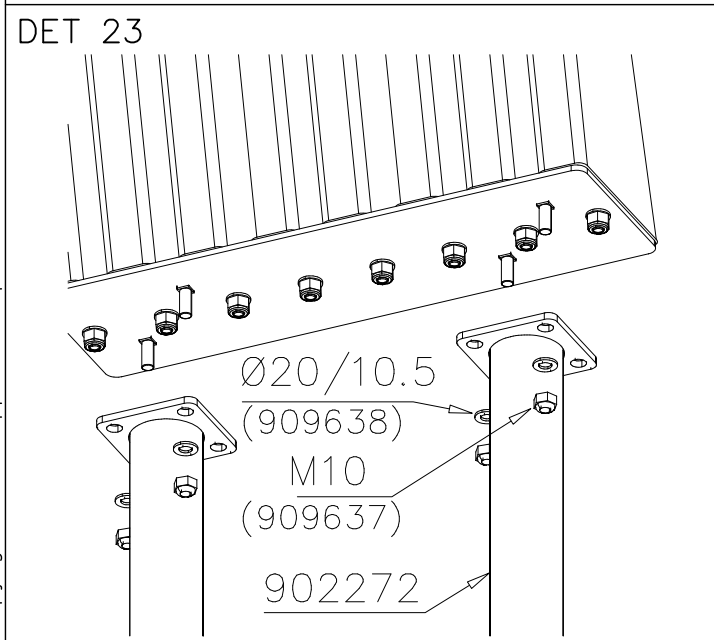
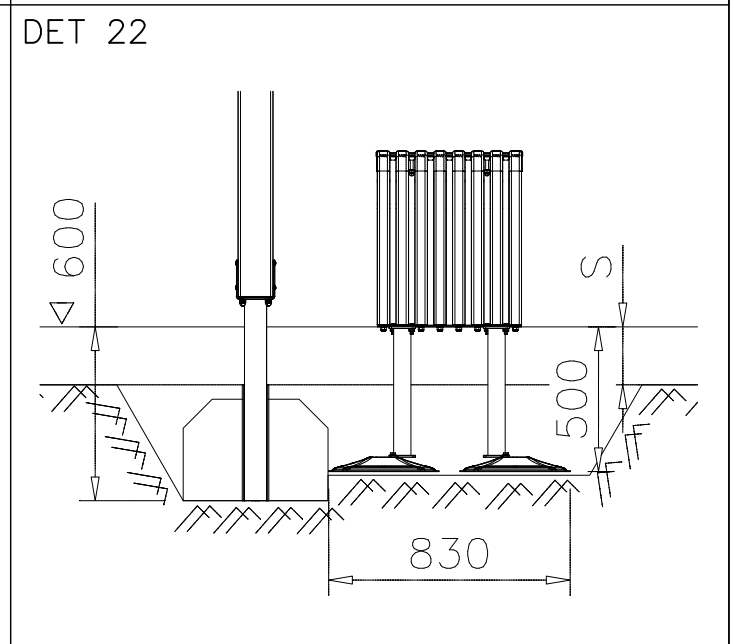
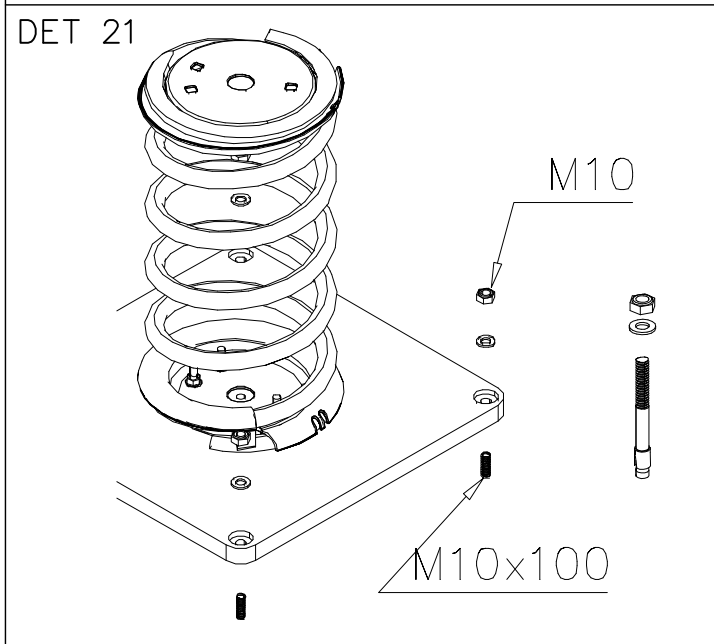
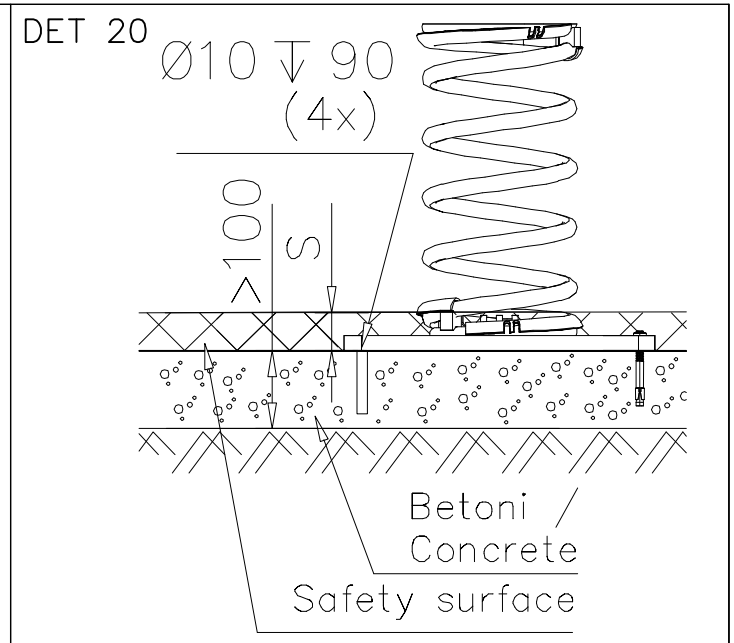
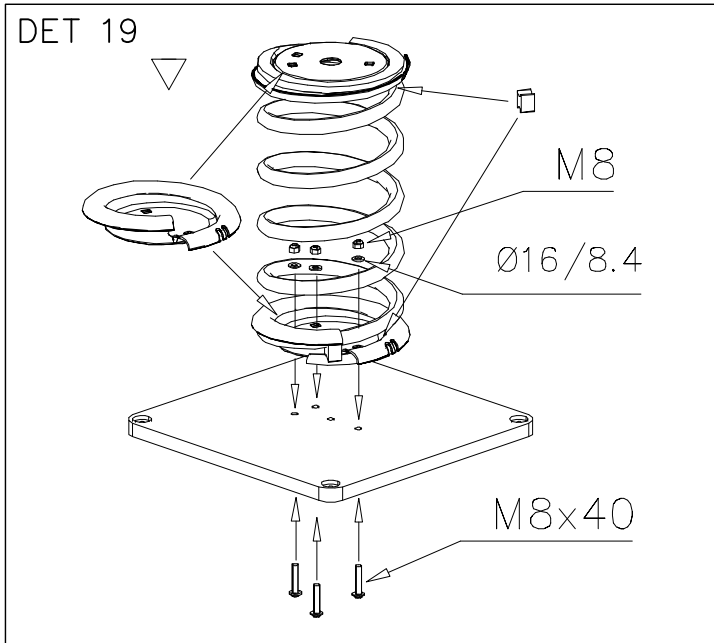

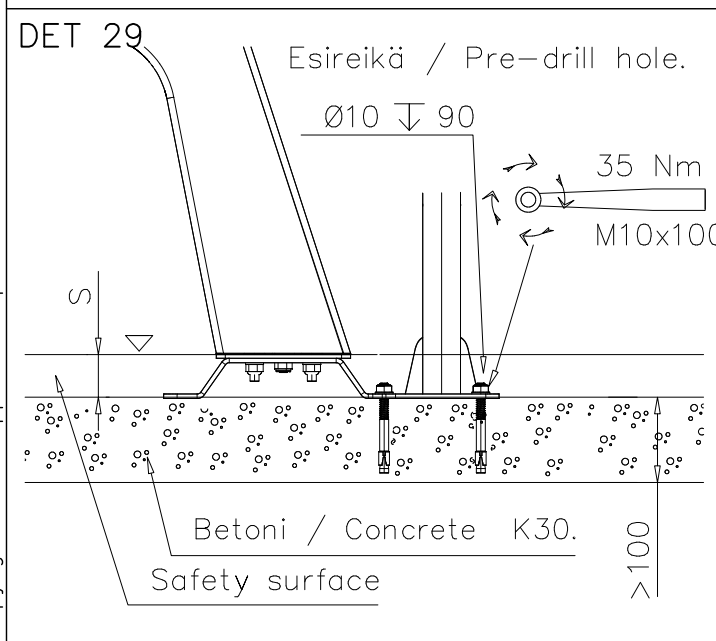
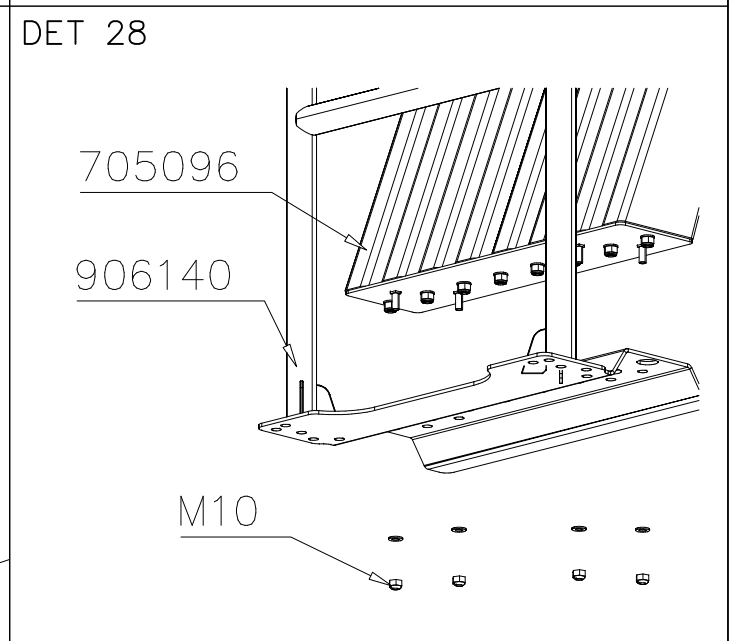
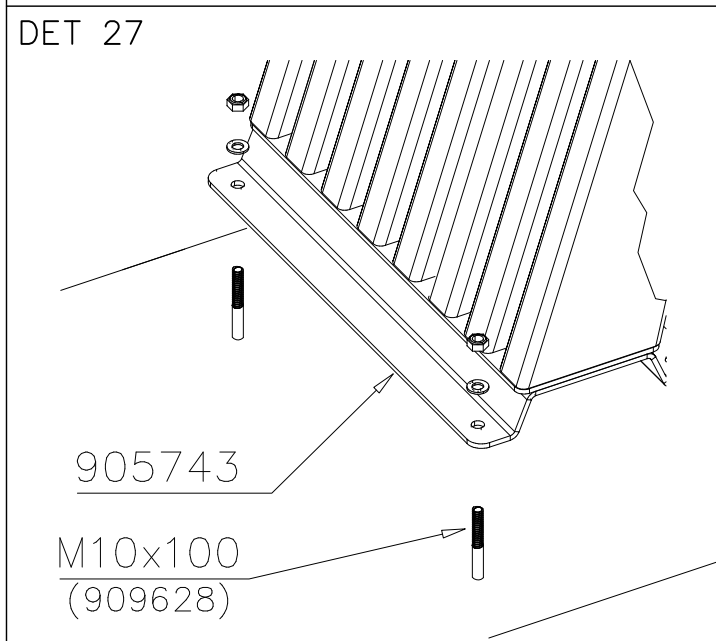
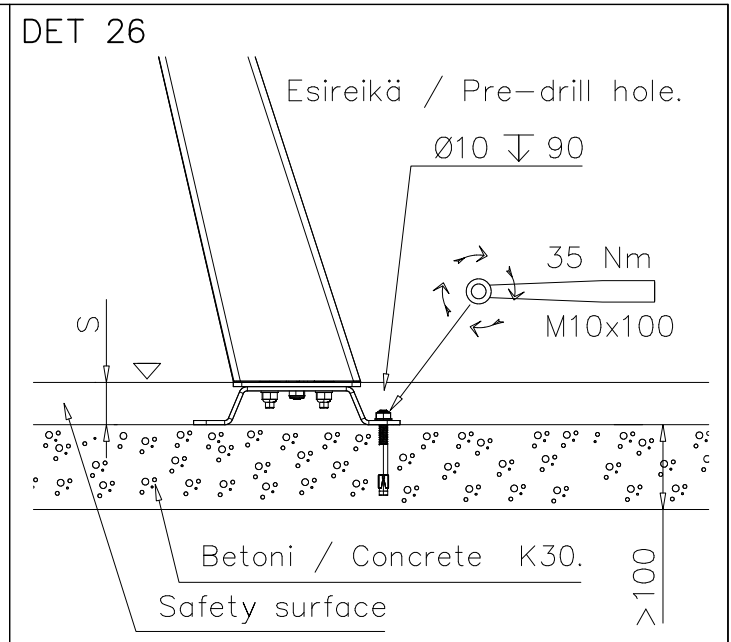
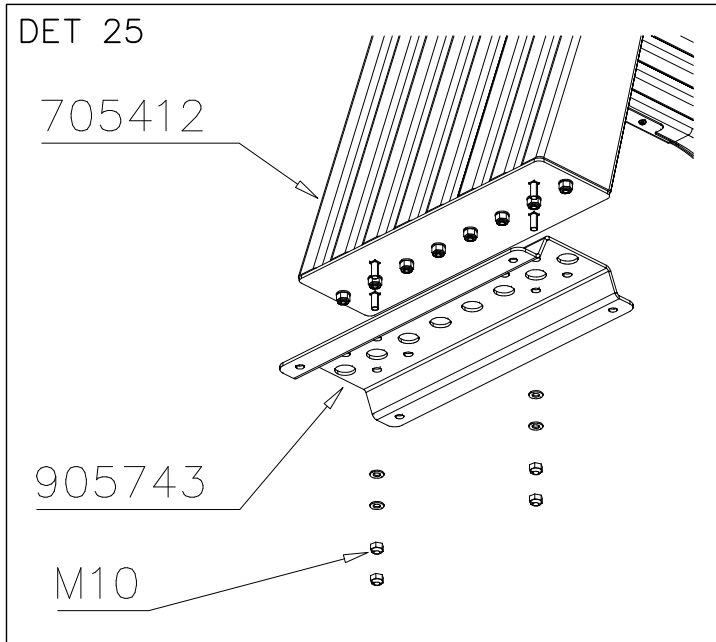

DET 31

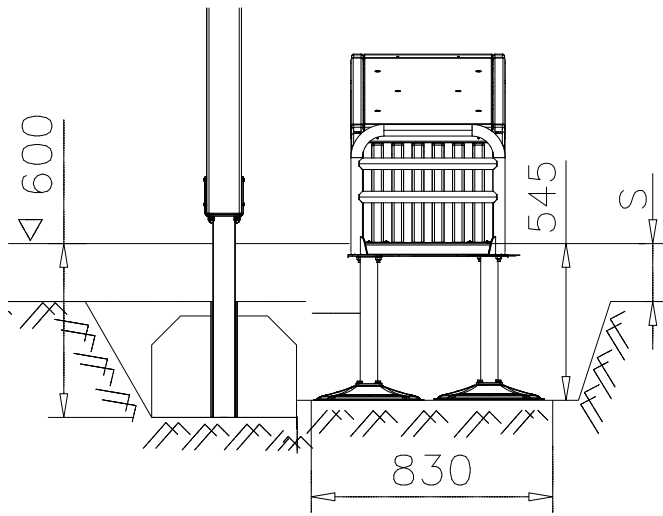

DET 32

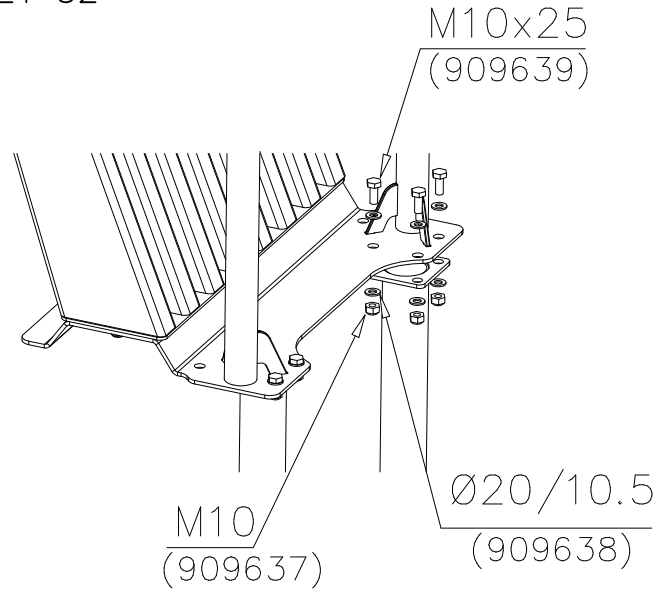

DET 33

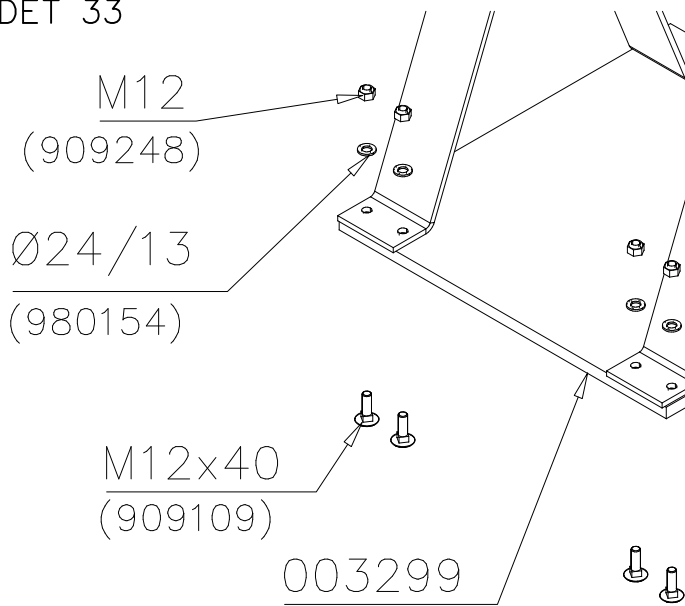

DET 34

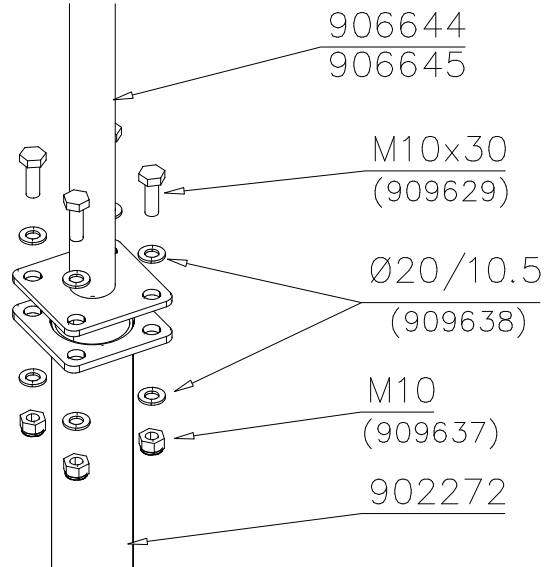

DET 35

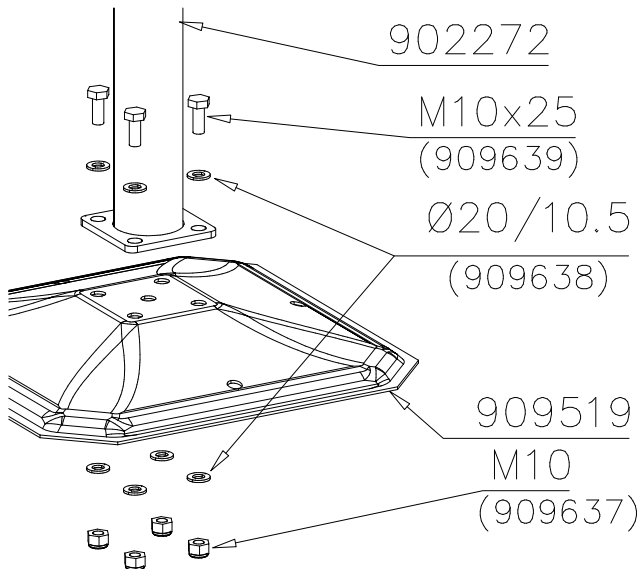

DET 36

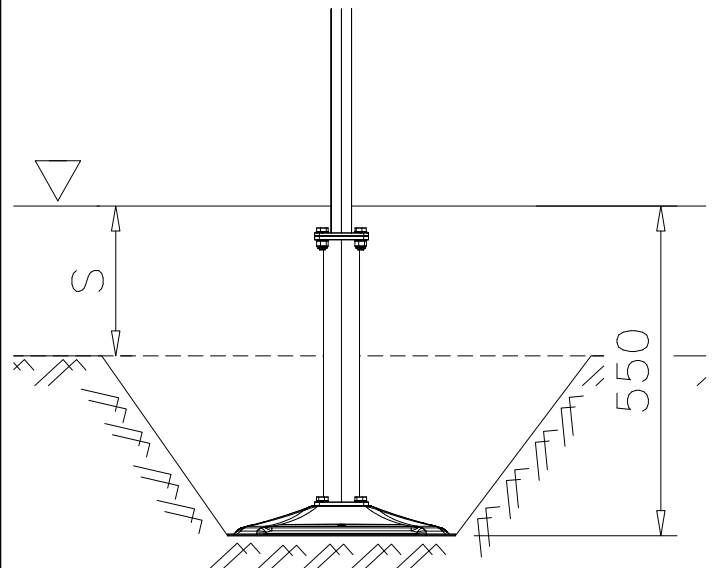

DET 37

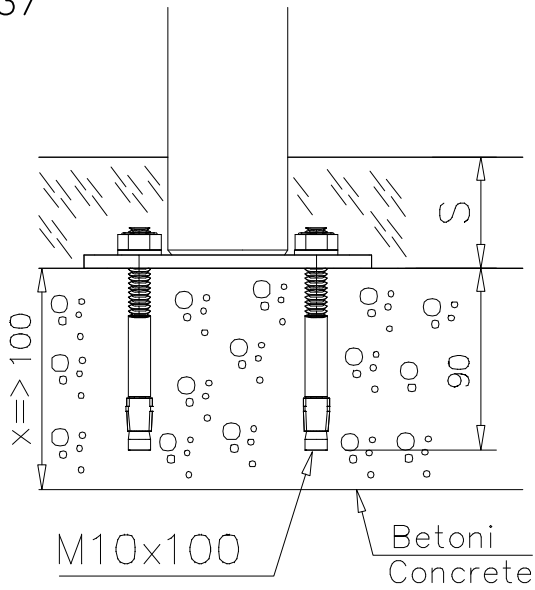

DET 38

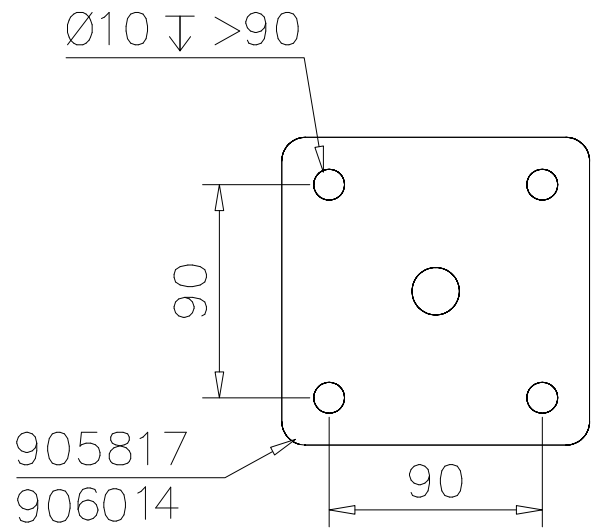

DET 39

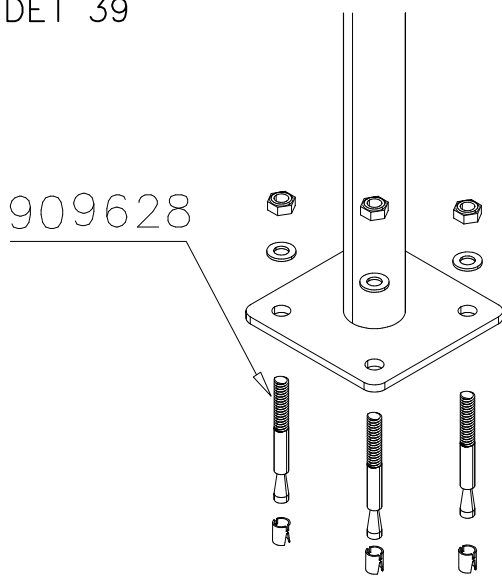

DET 40

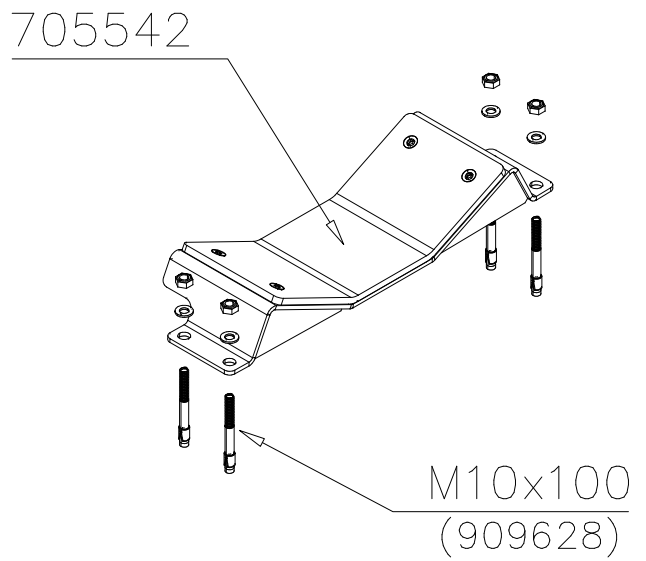

DET 41

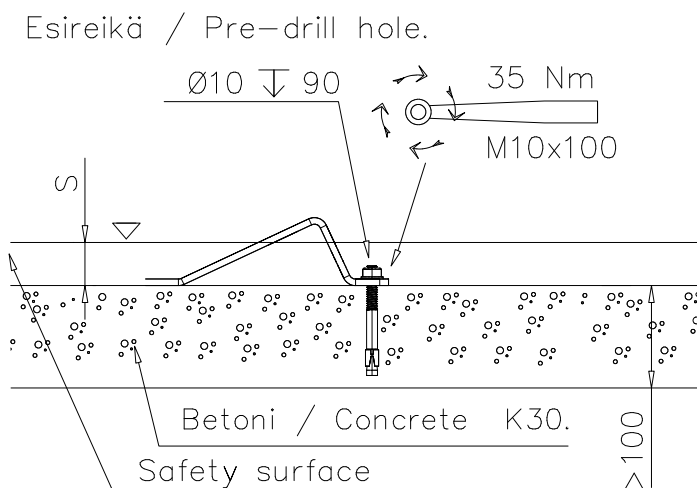

DET 42

LAPPSET SPORT

BASE

DATE: 15.8.2017

8(10)

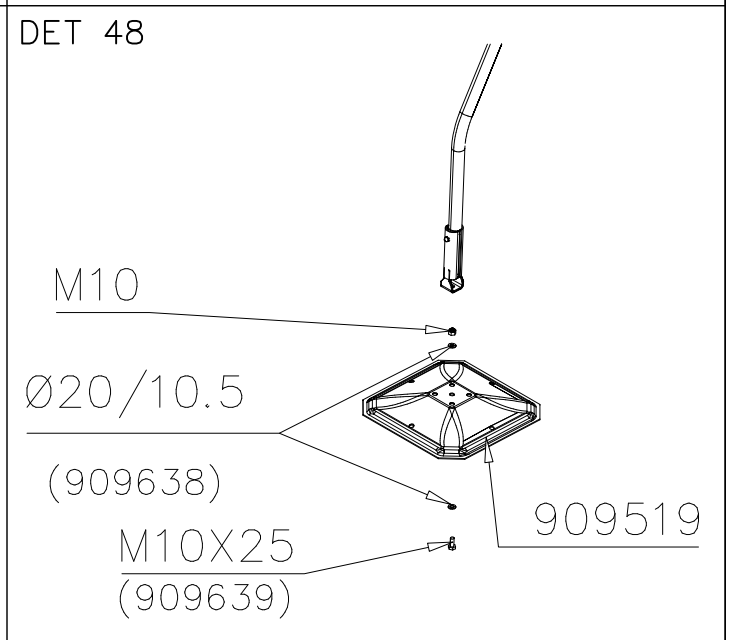
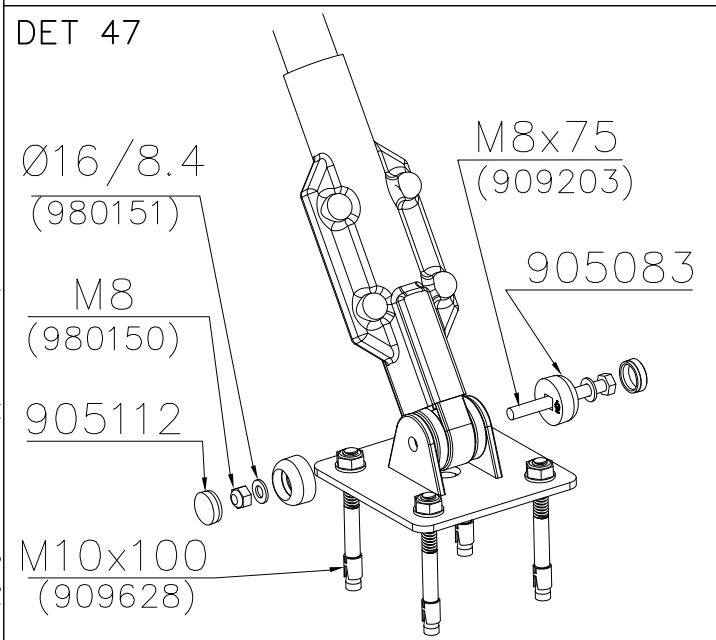
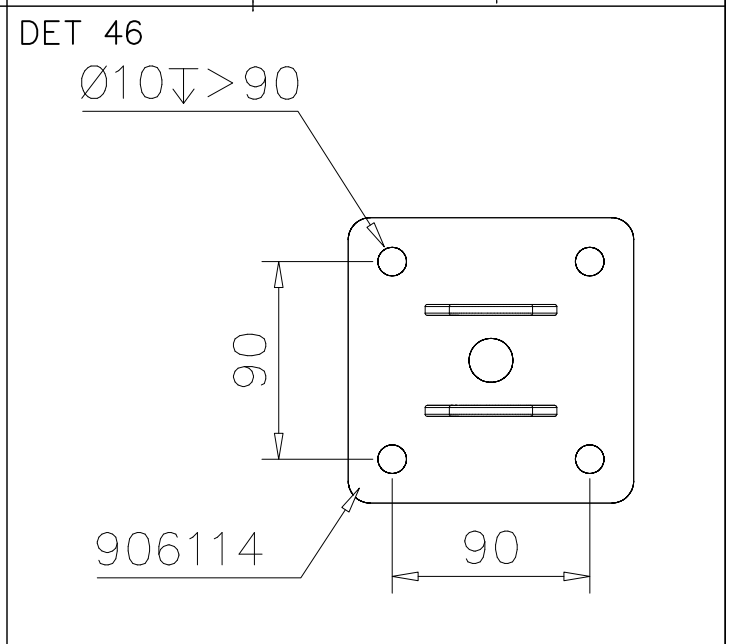
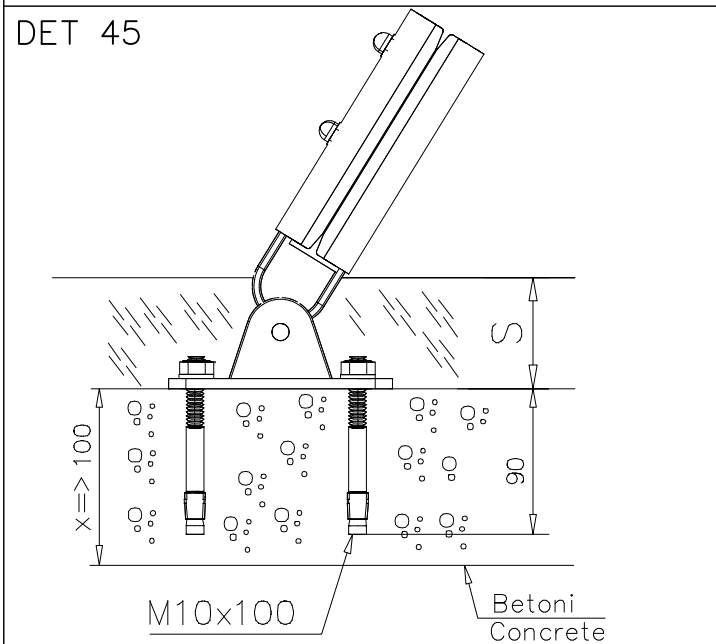
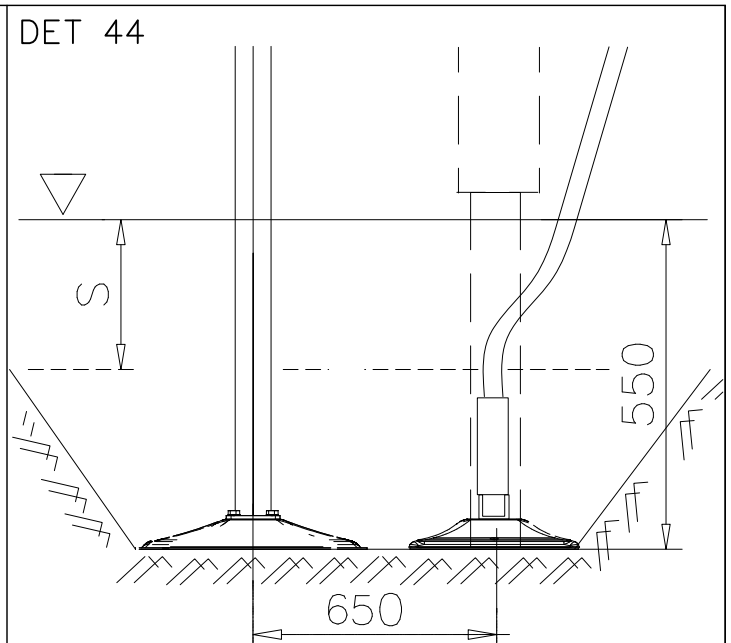
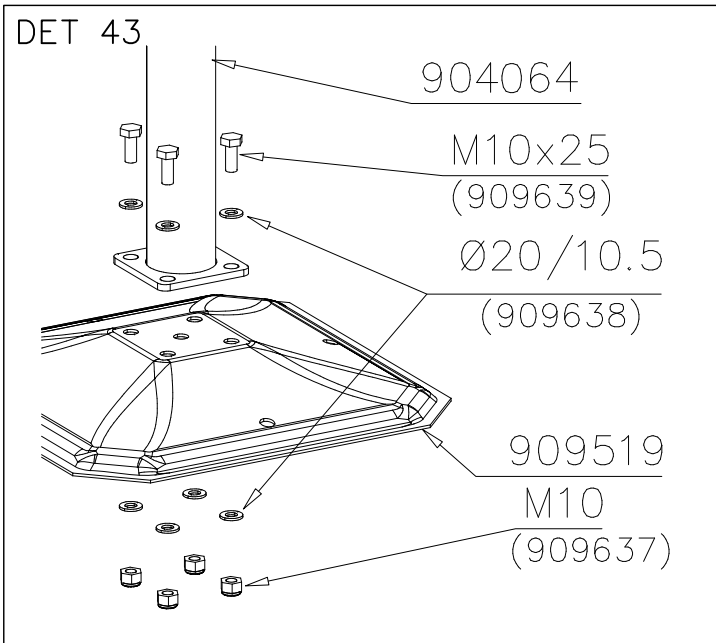

DET 49

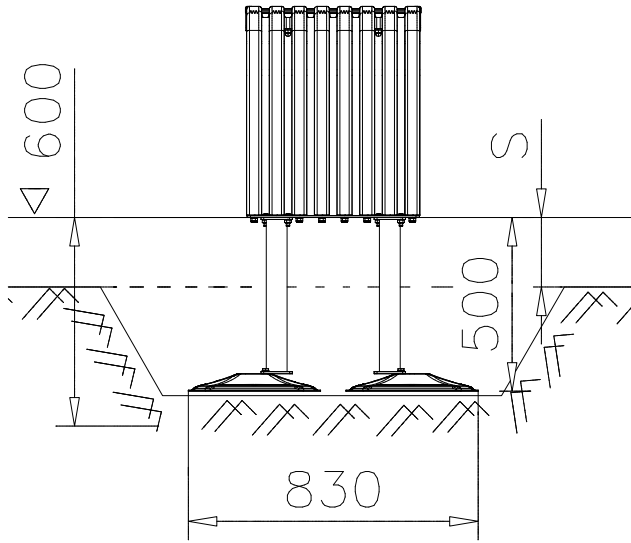

DET 50

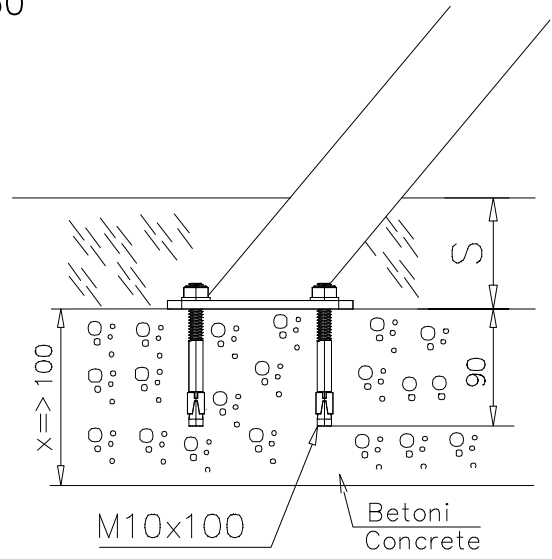

DET 51

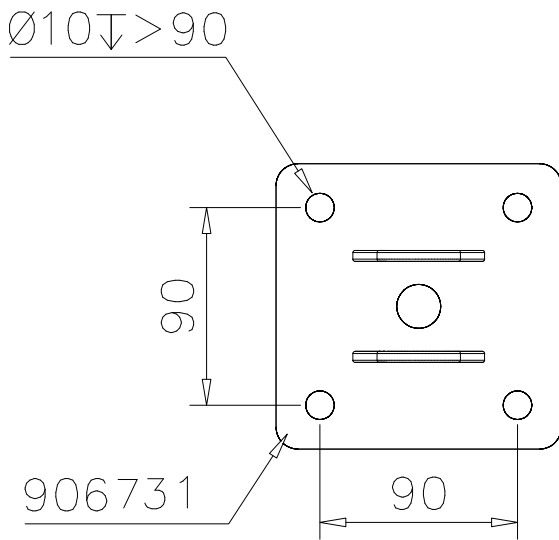

DET 52

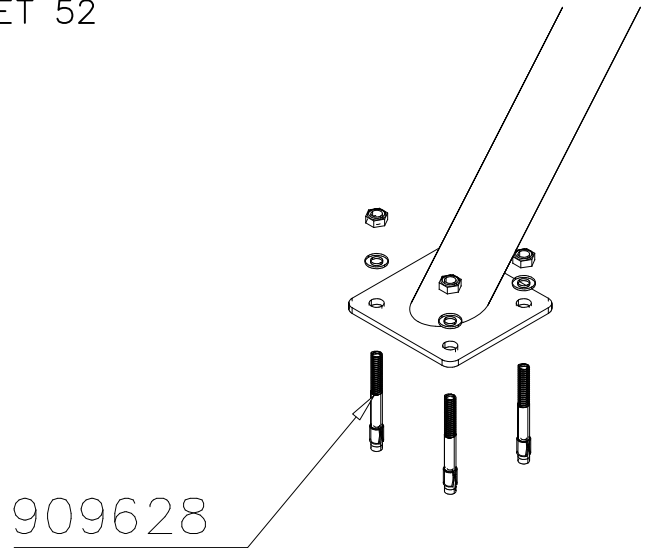

DET 53

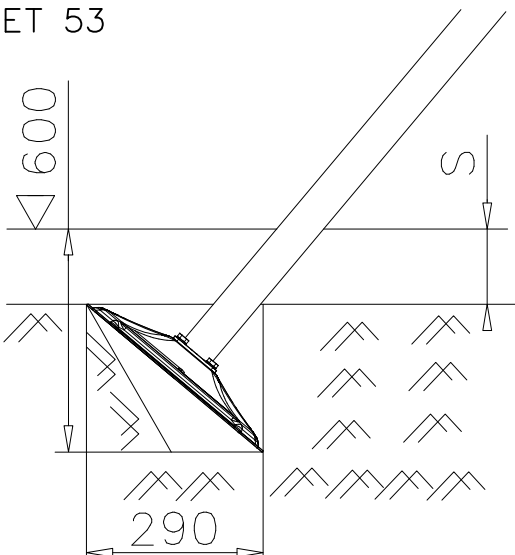

DET 54

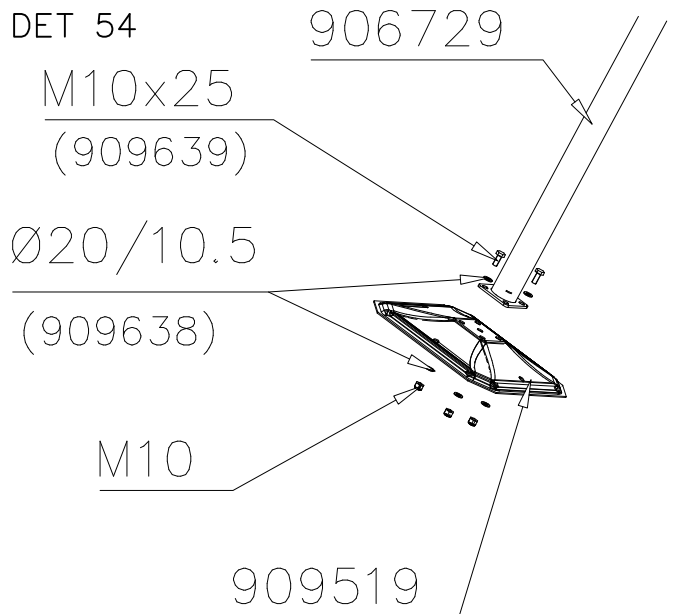

DET 55

STEELNET Ø6 #150
(1400x2100)
Concrete
1500X2200X200 K30

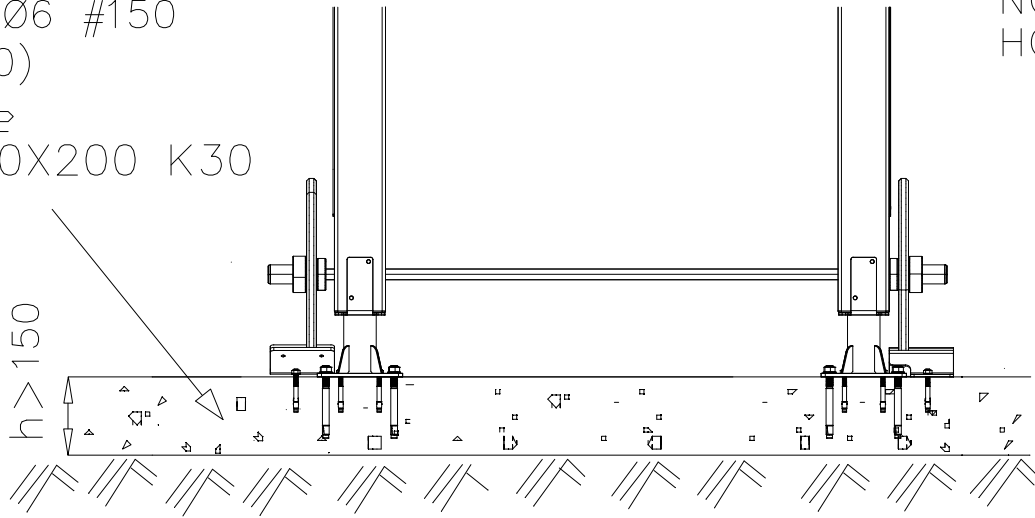

NOTE!
HOX!

DET 56

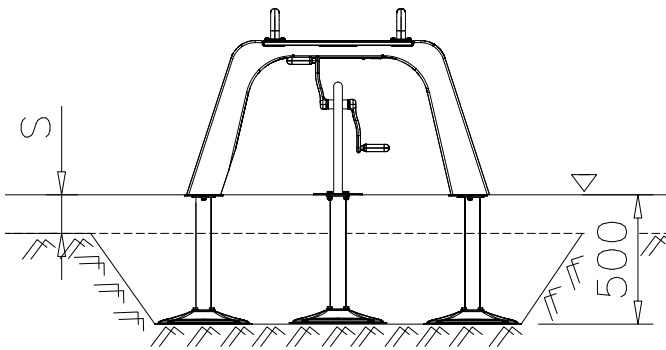

DET 57

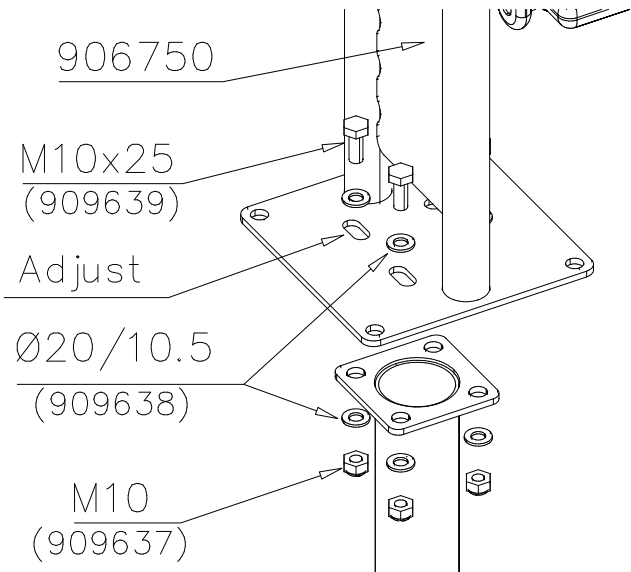

DET 58

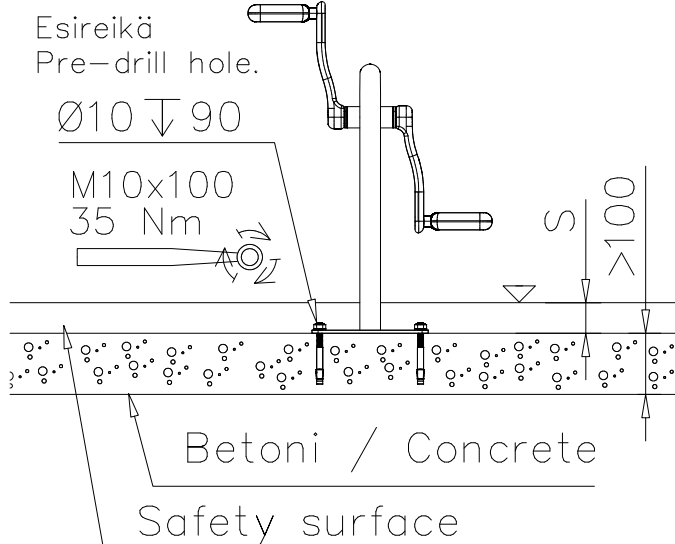

DET 59

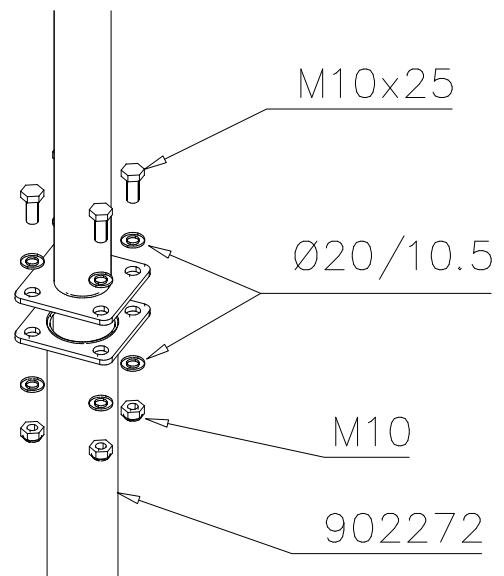

DET 1

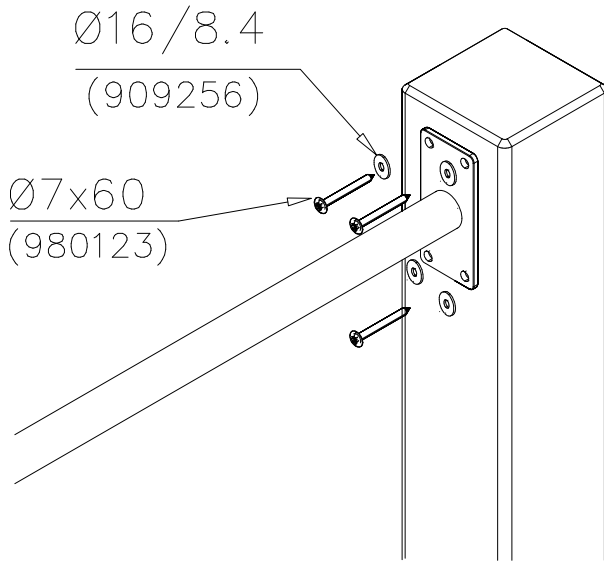

DET 2

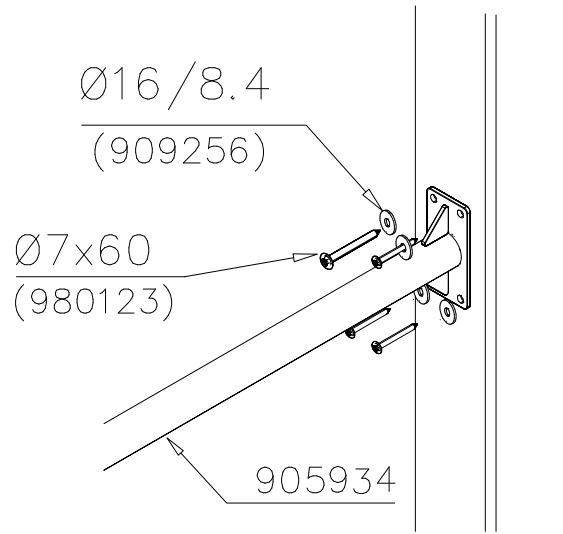

DET 3

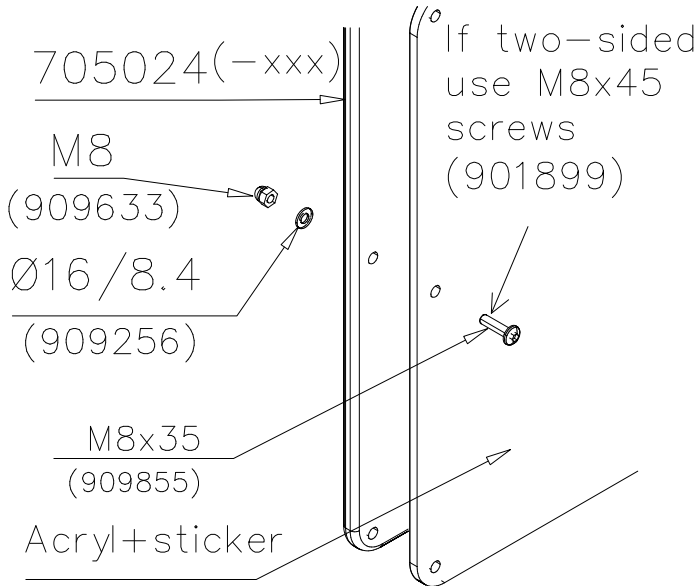

DET 4

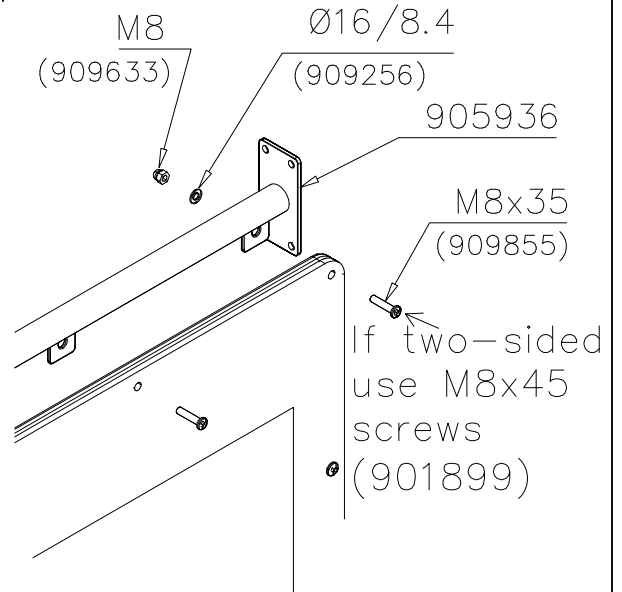

DET 5

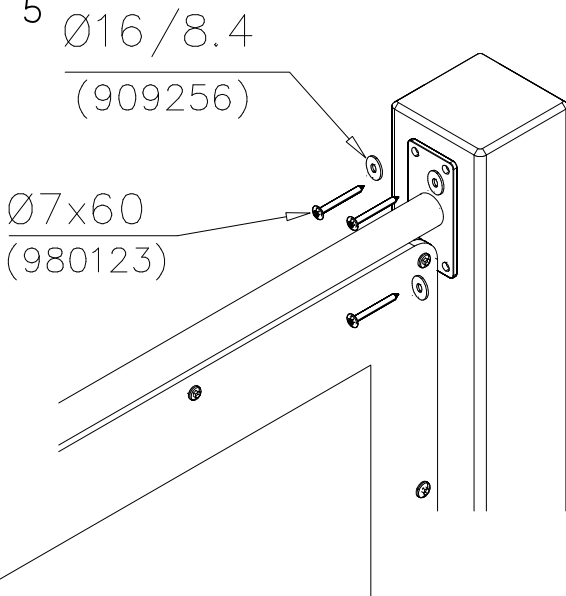

DET 6

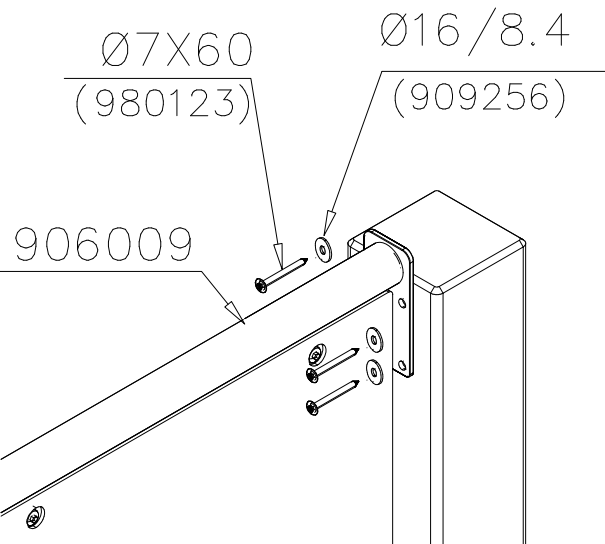

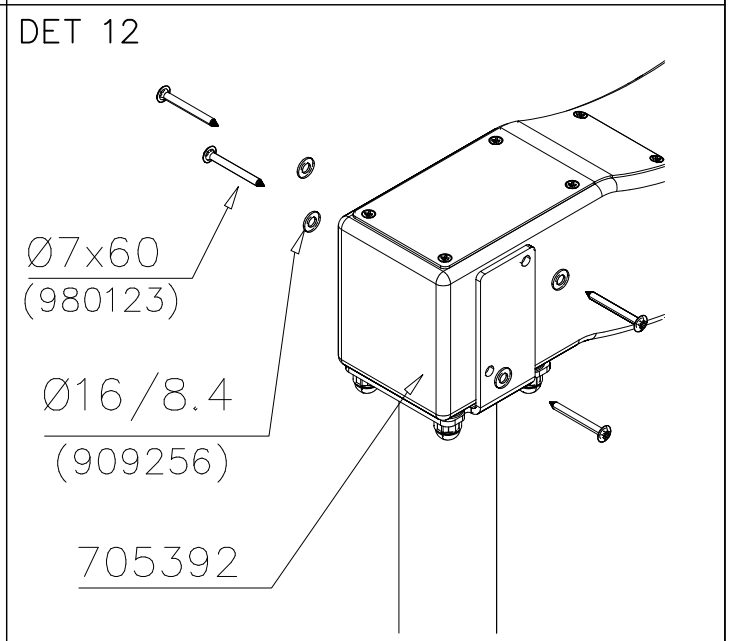
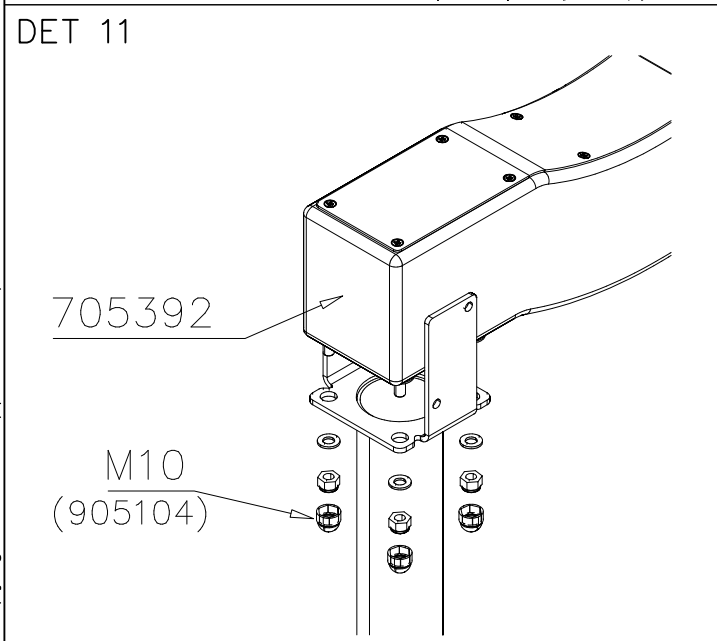
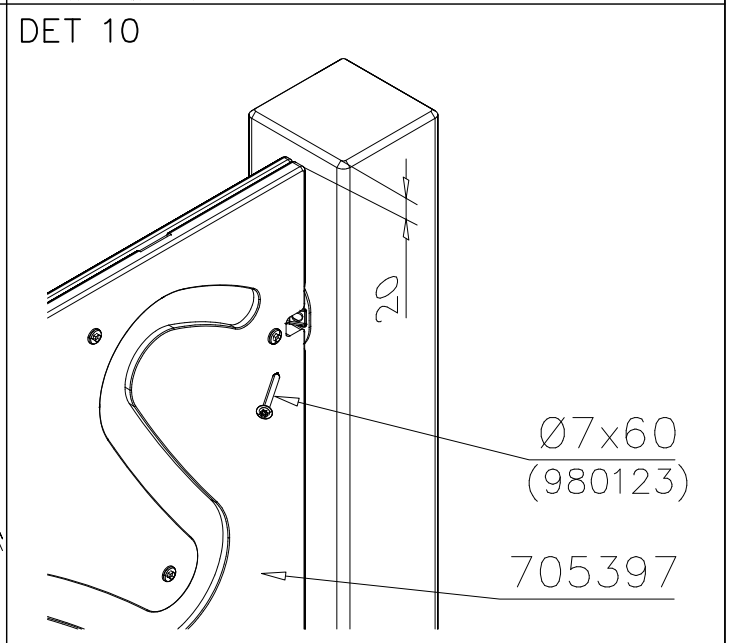
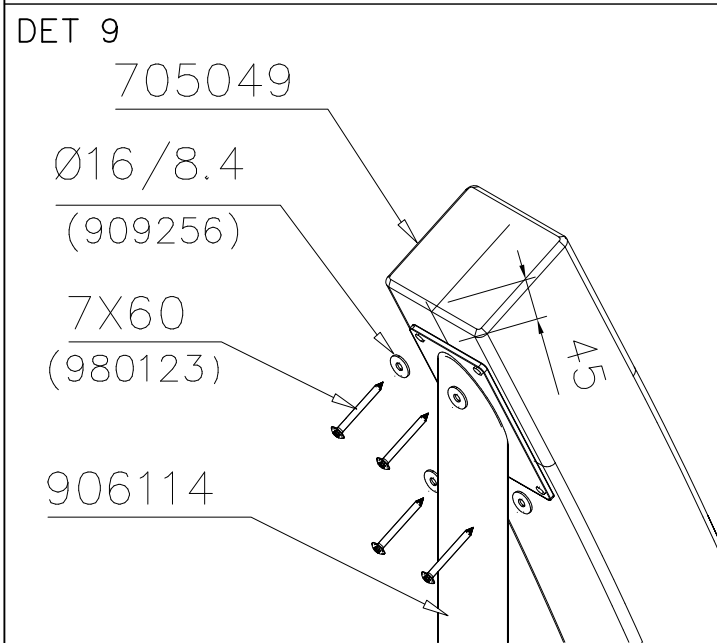
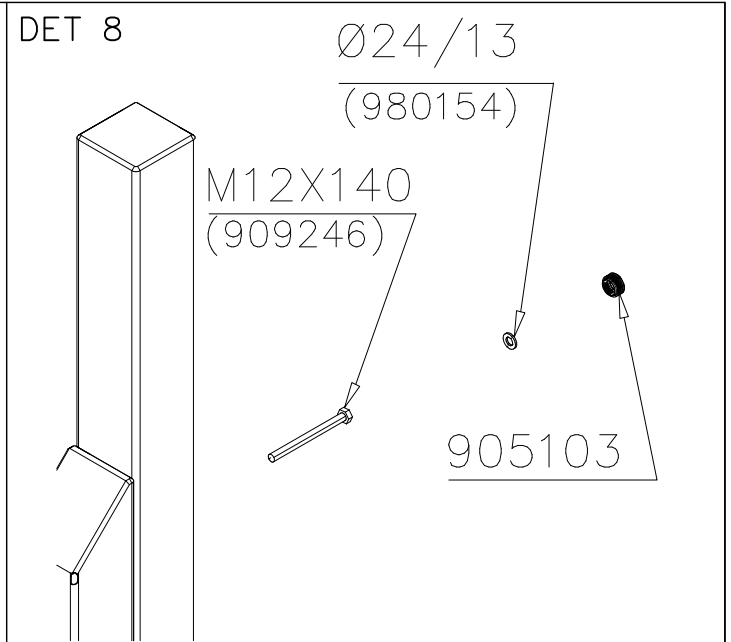
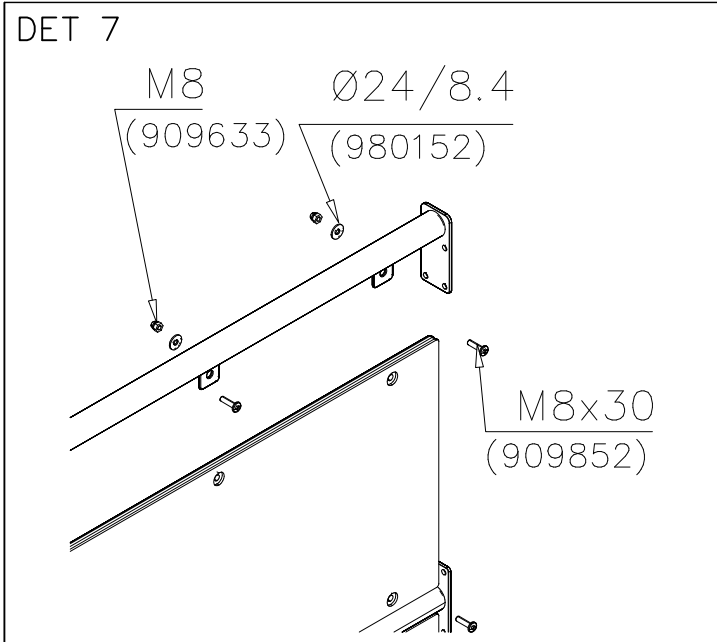

DET 13

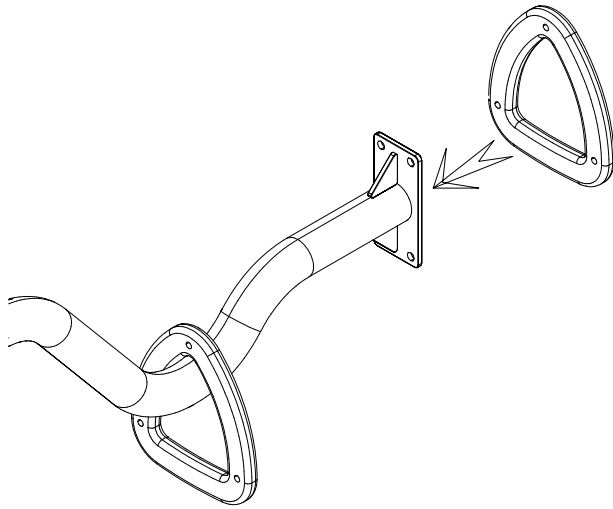

DET 14

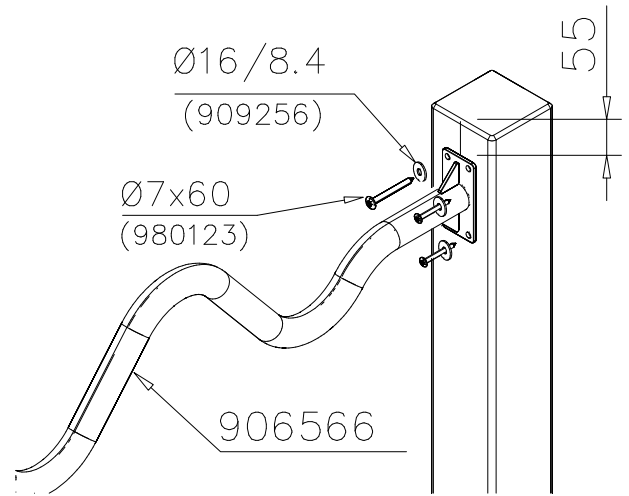

DET 15

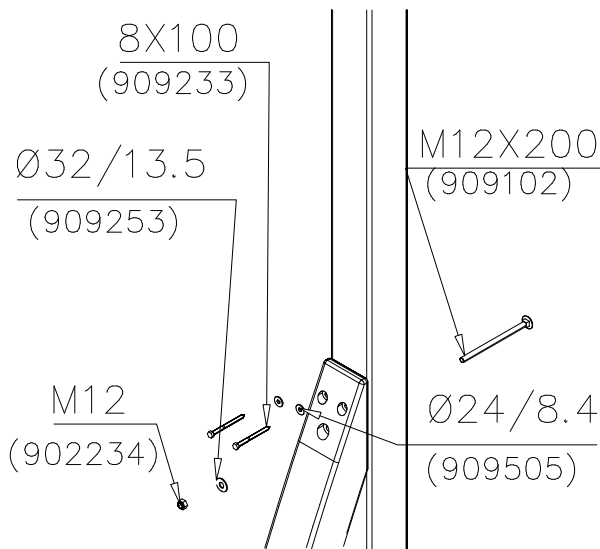

DET 16

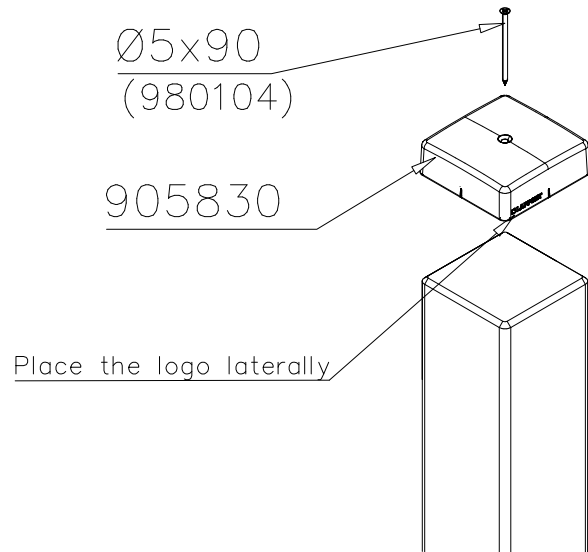

DET 17

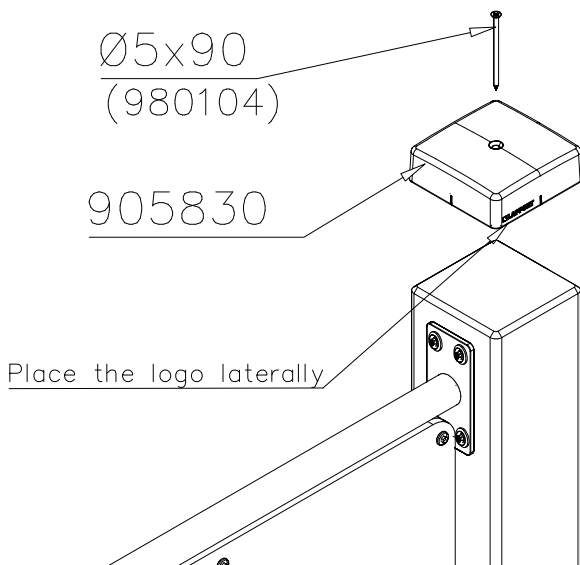

DET 18

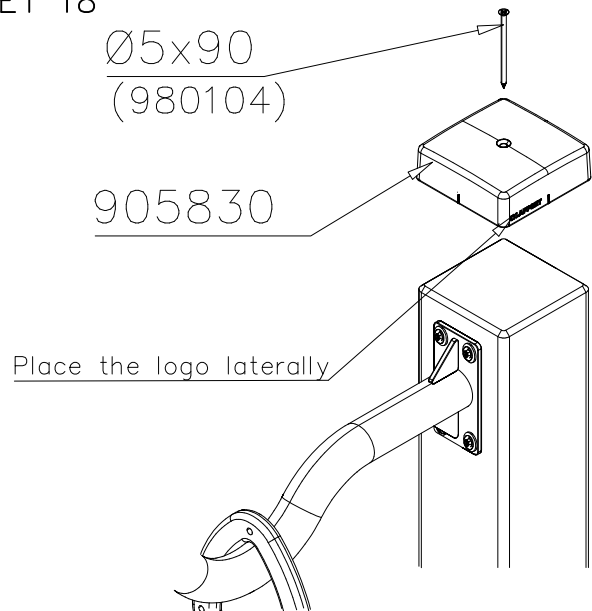

DET 19

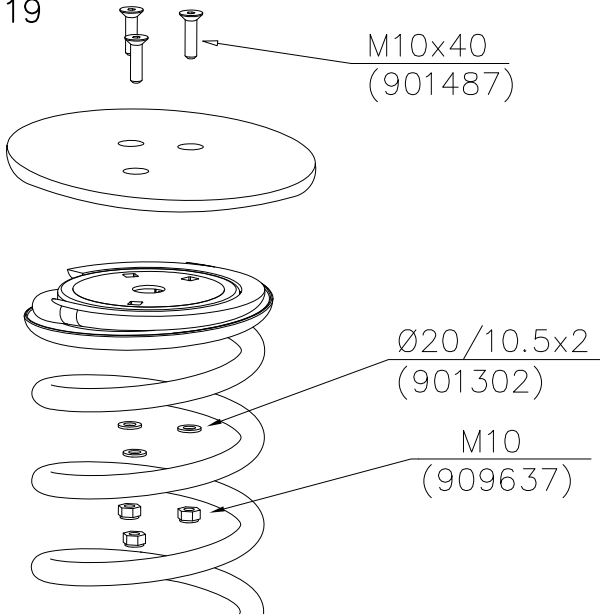

DET 20

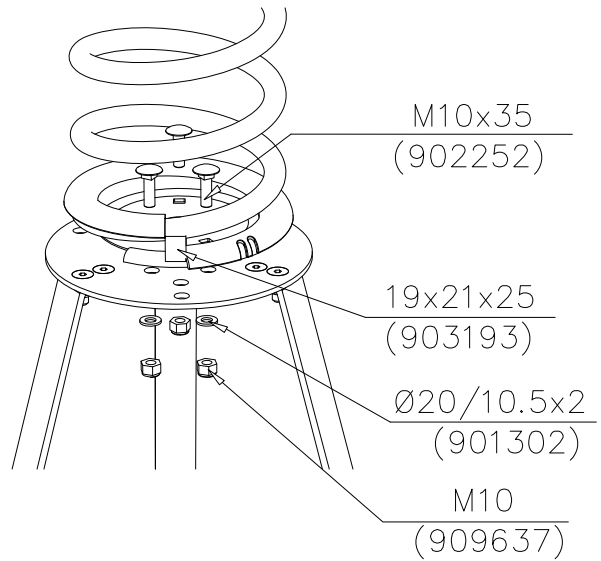

DET 21

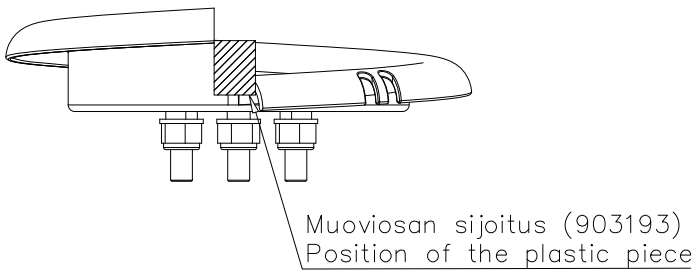

DET 22

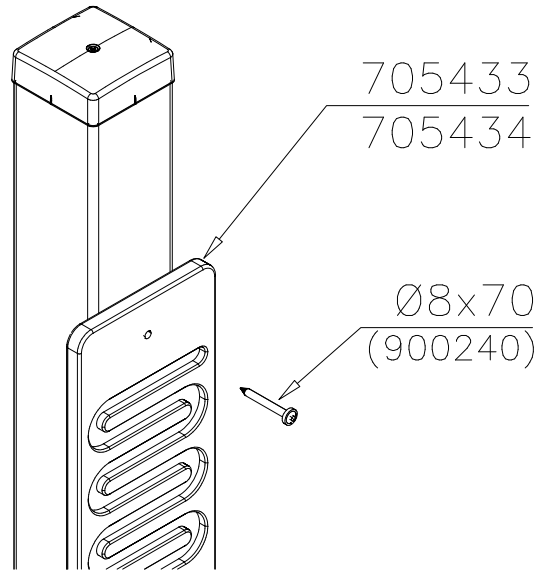

DET 23

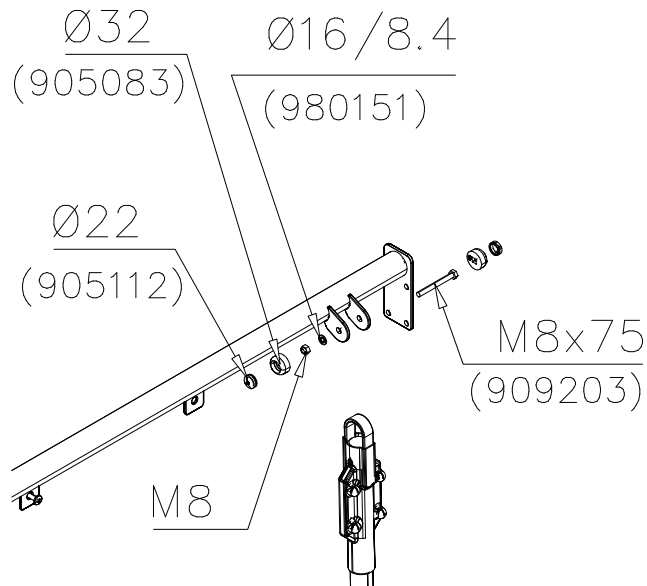

DET 24

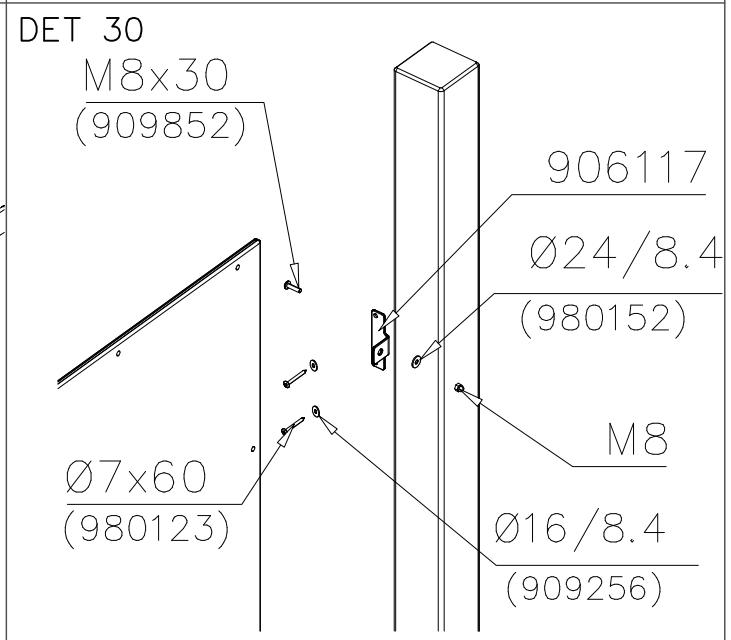
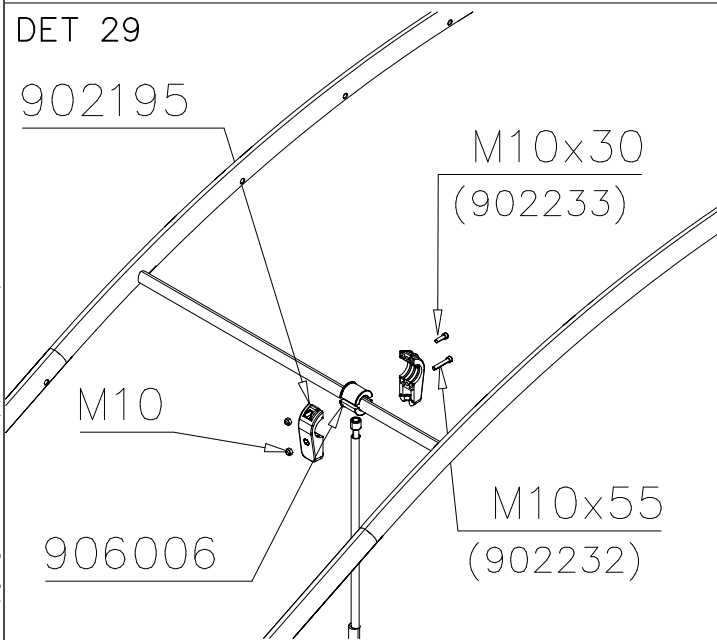
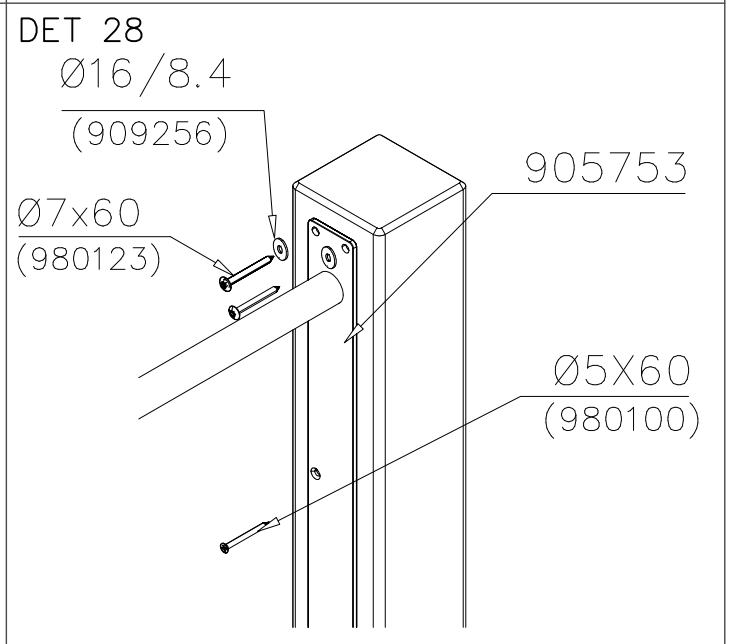
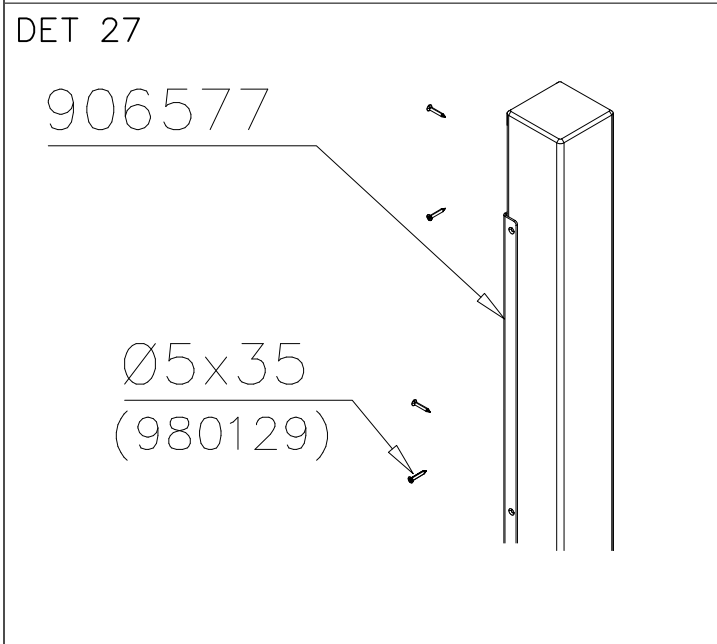
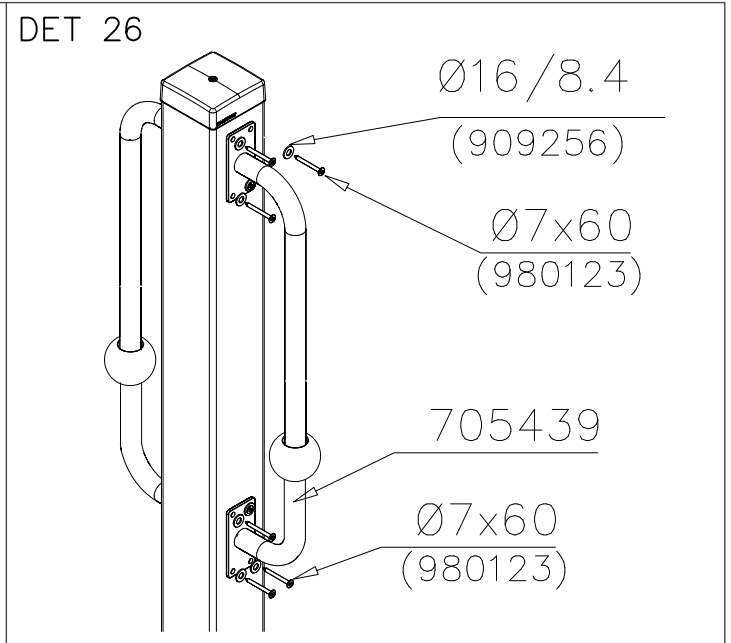
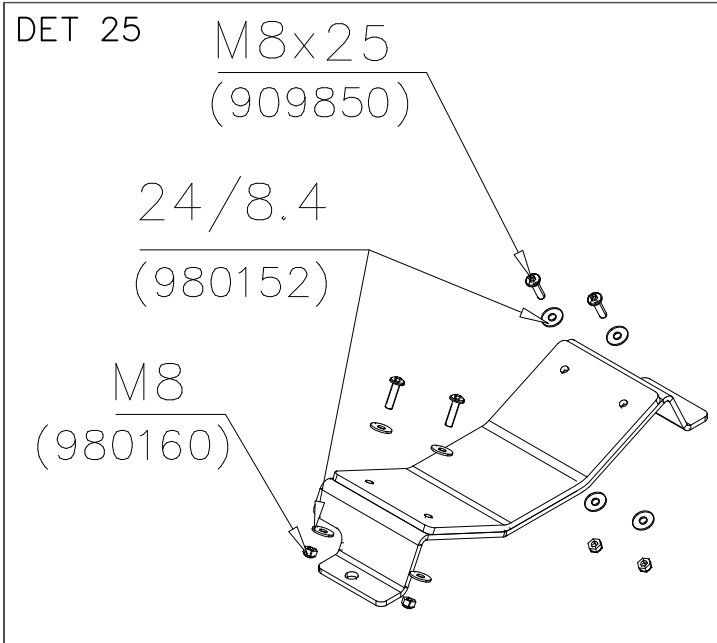

DET 31

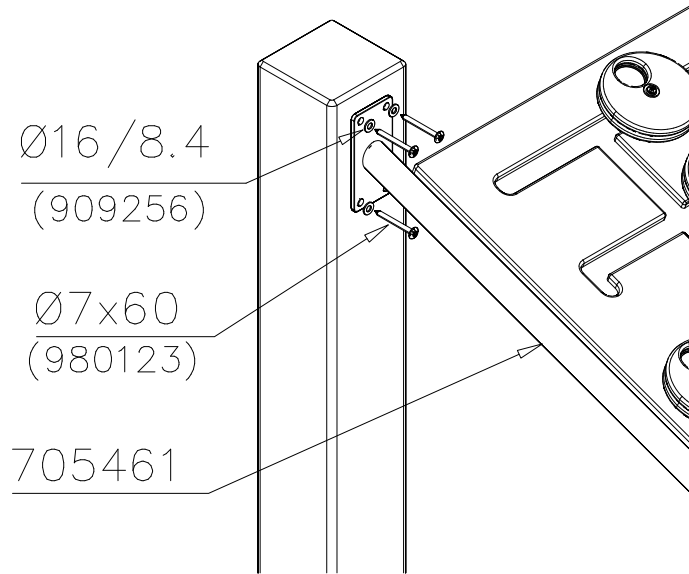

DET 32

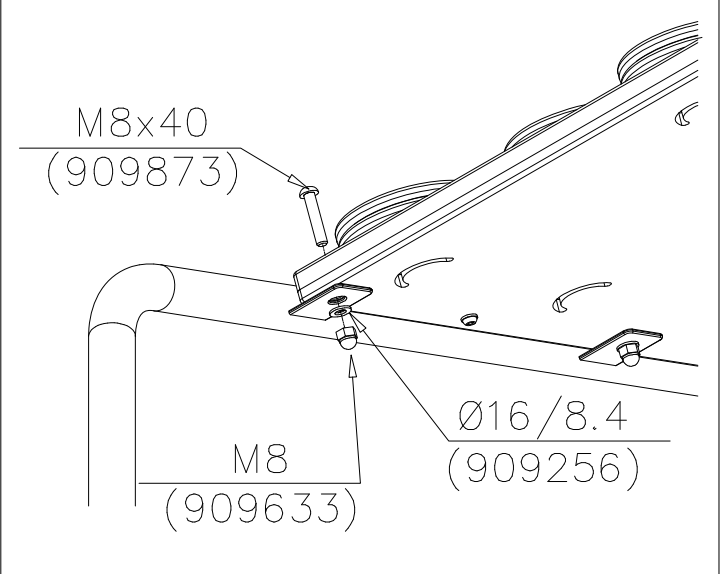

DET 33

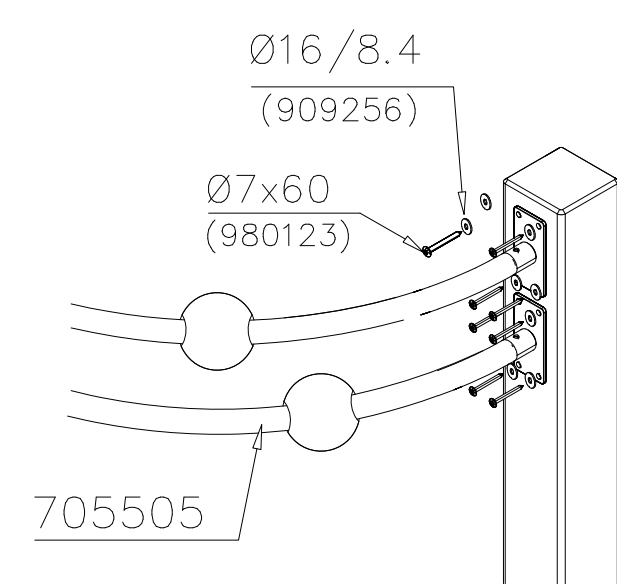

DET 34

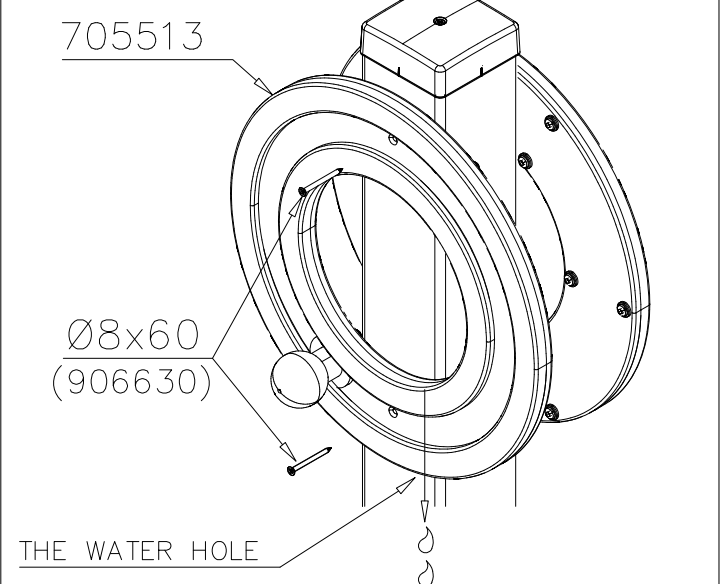

DET 35

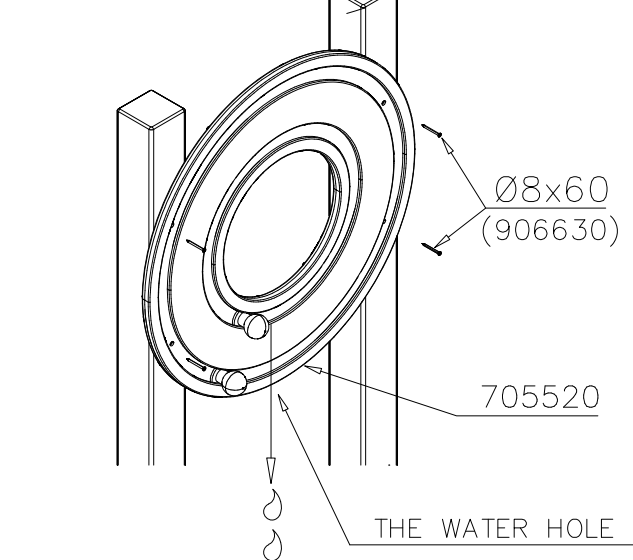

DET 36

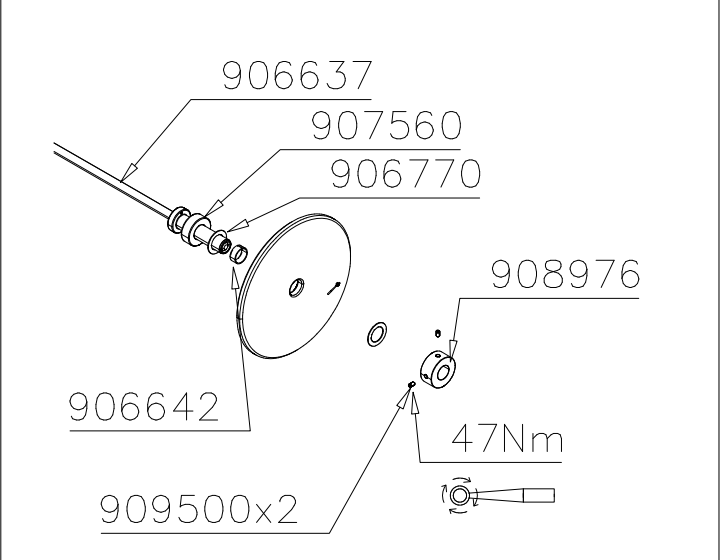

DET 37

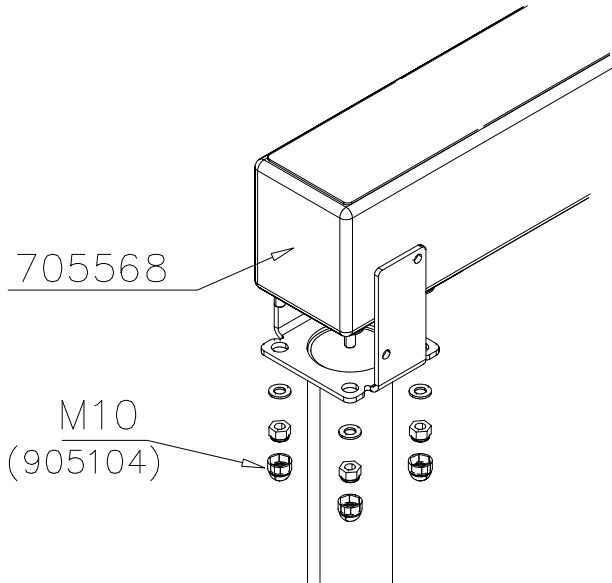

DET 38

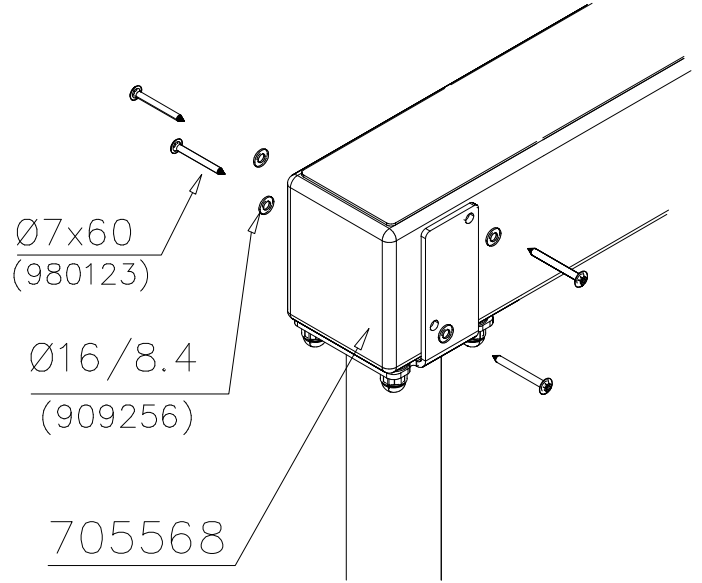

DET 39

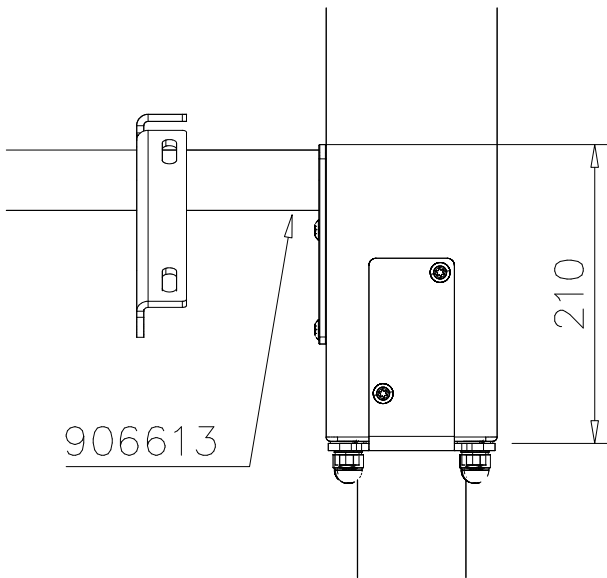

DET 40

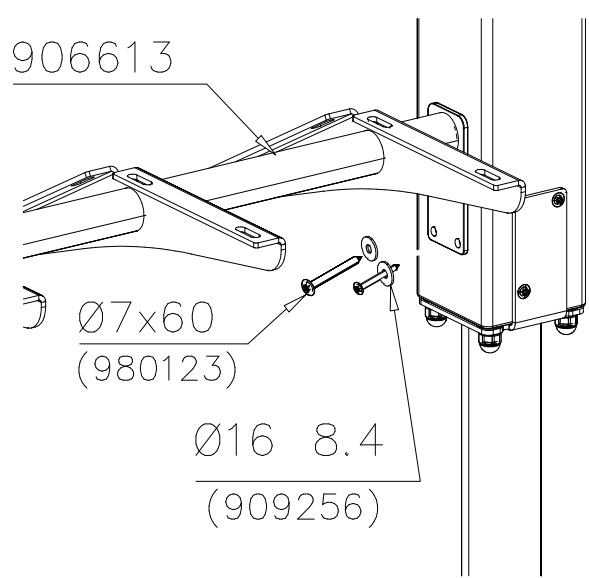

DET 41

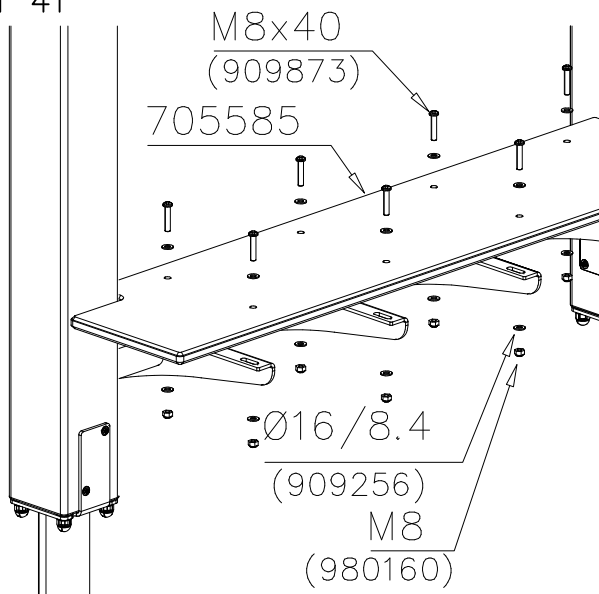

DET 42

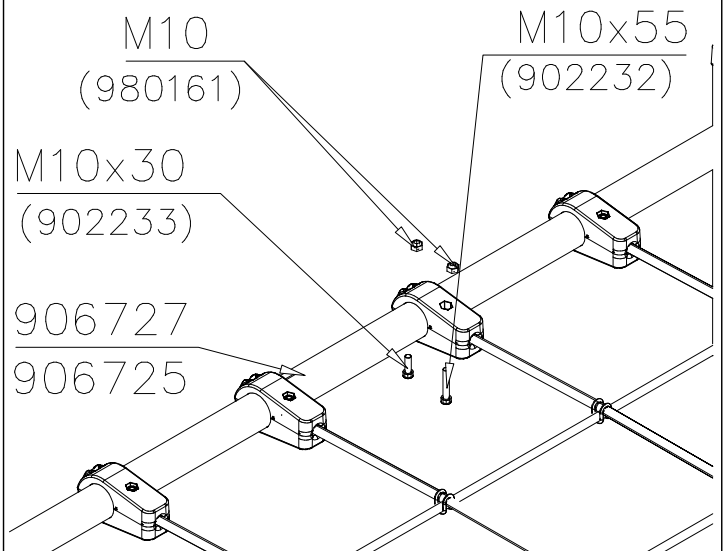

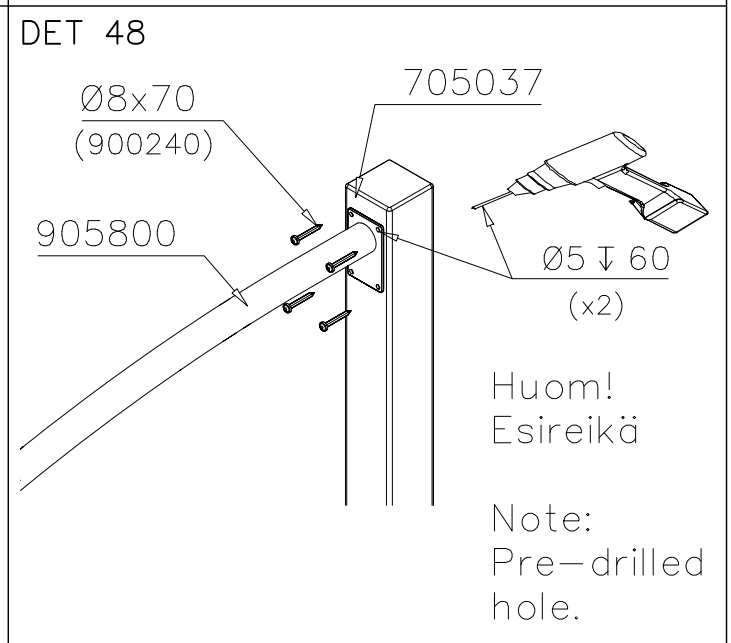
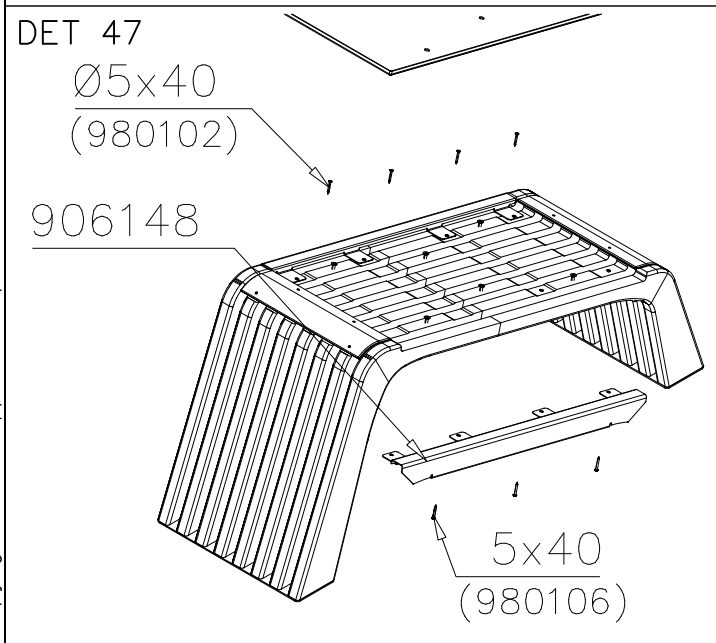
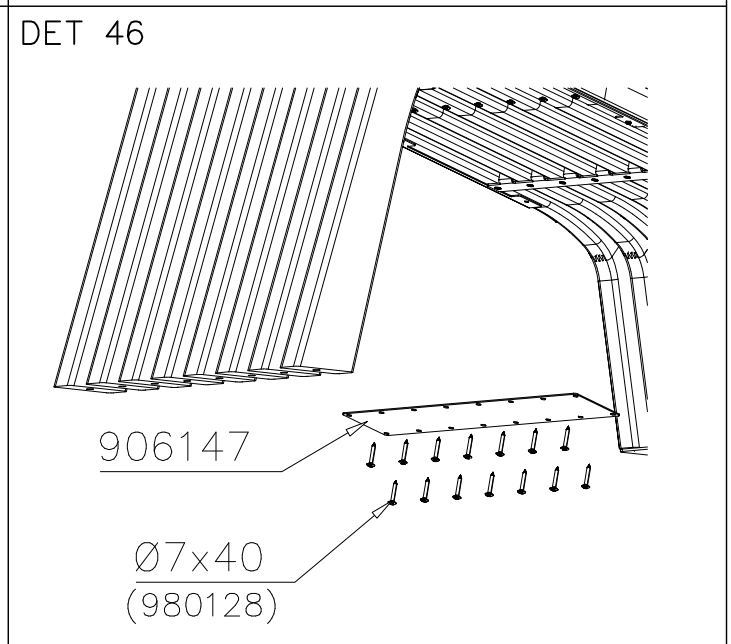
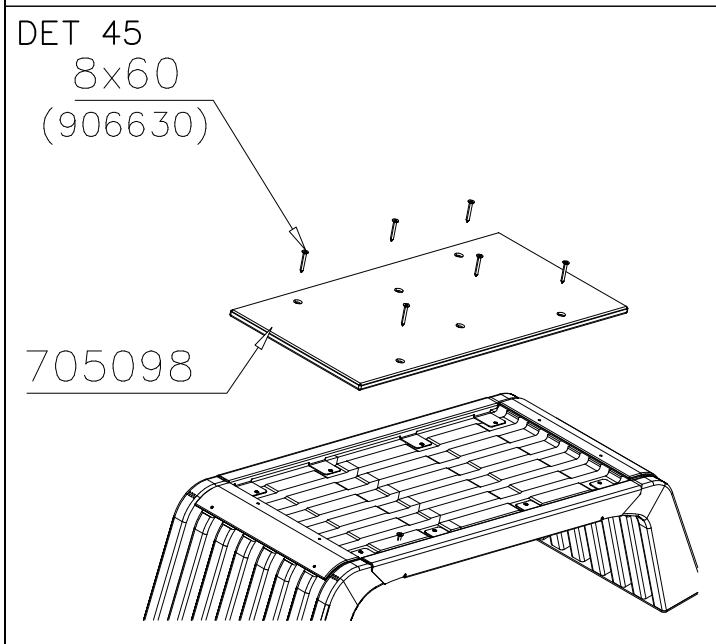
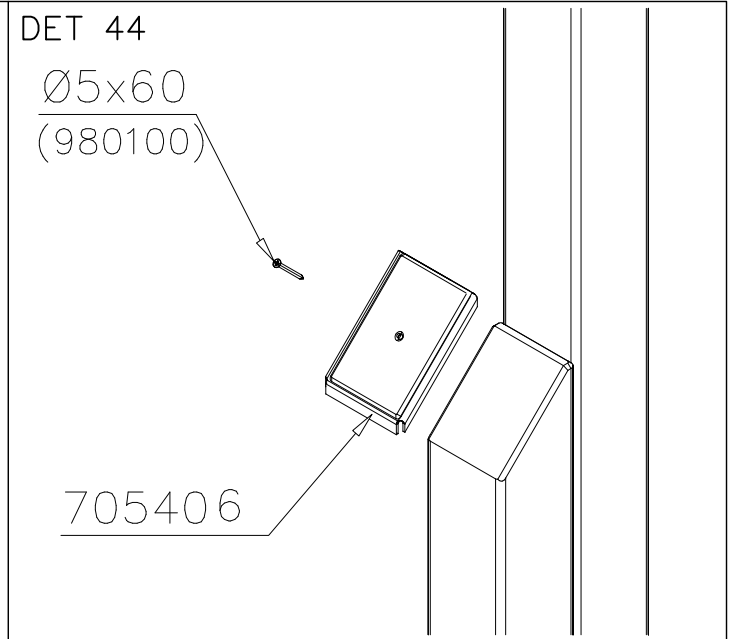
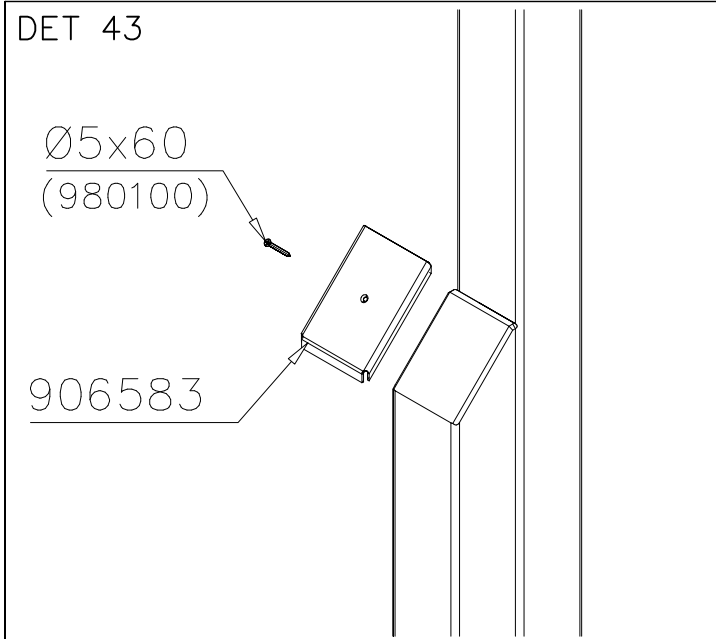

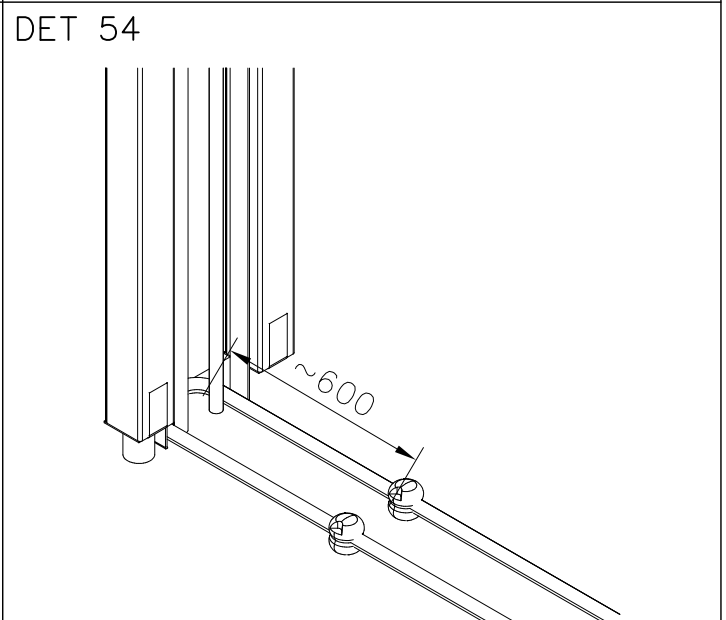
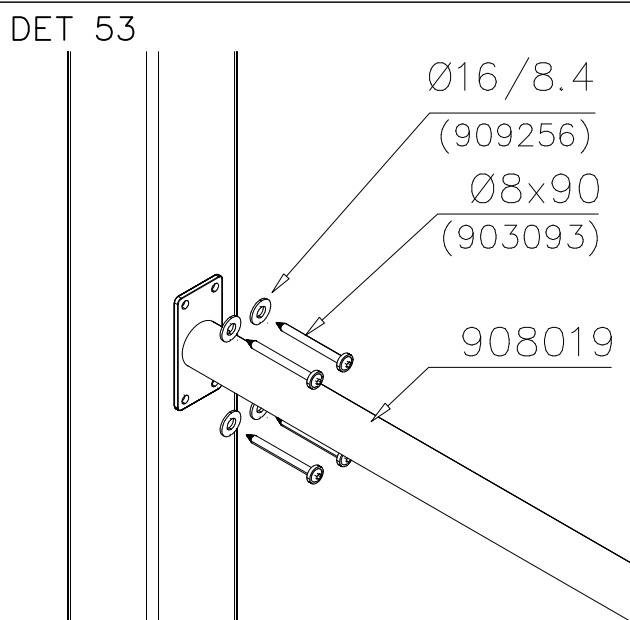
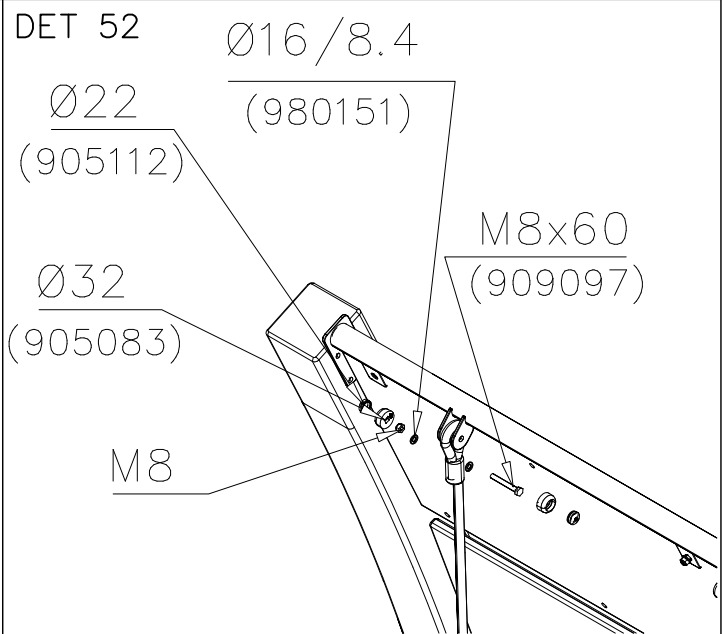
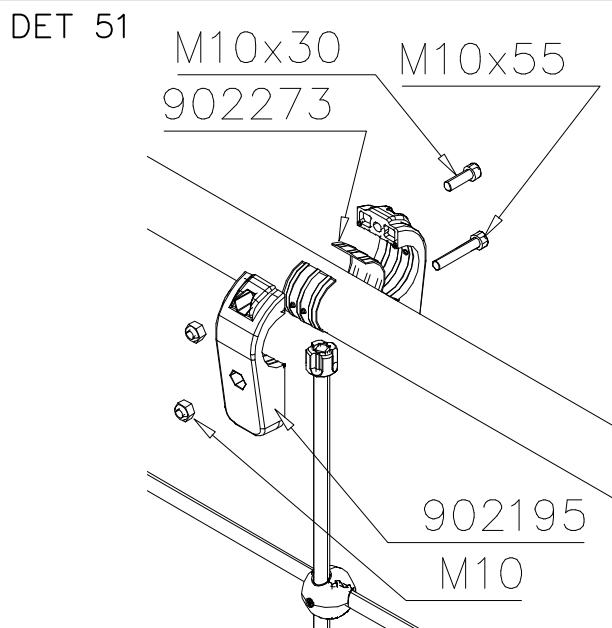
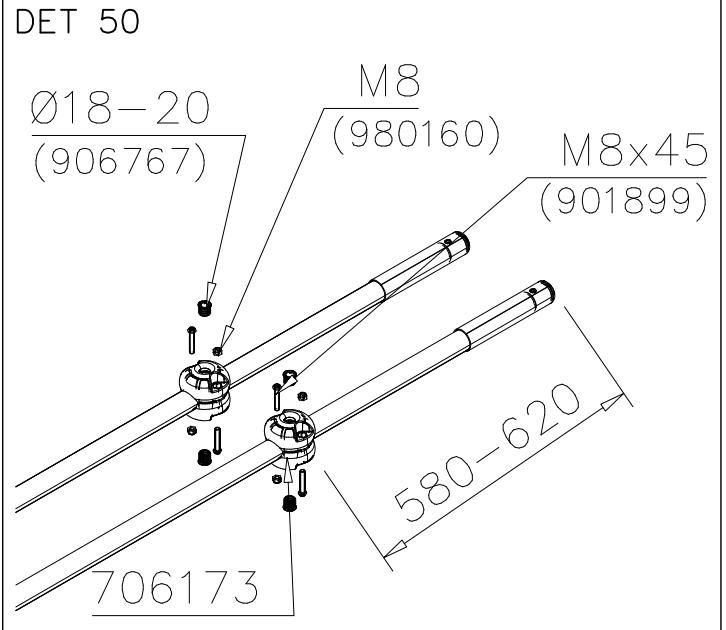
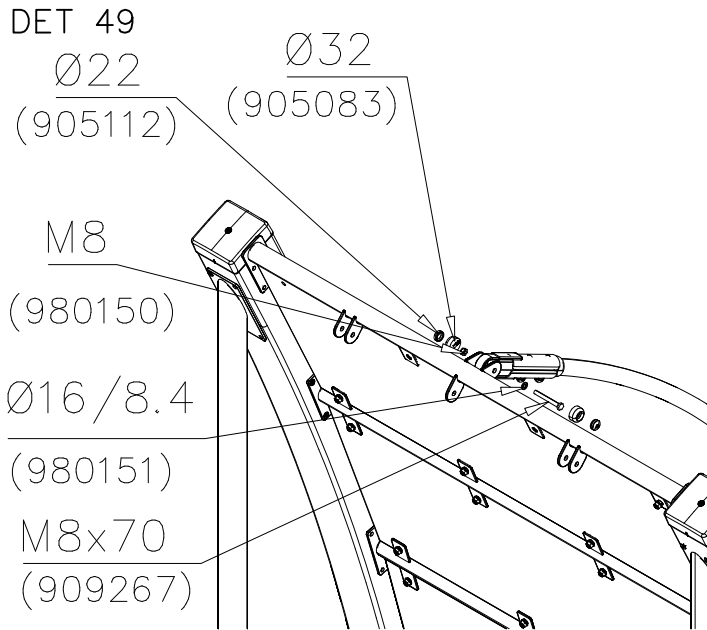

DET 55

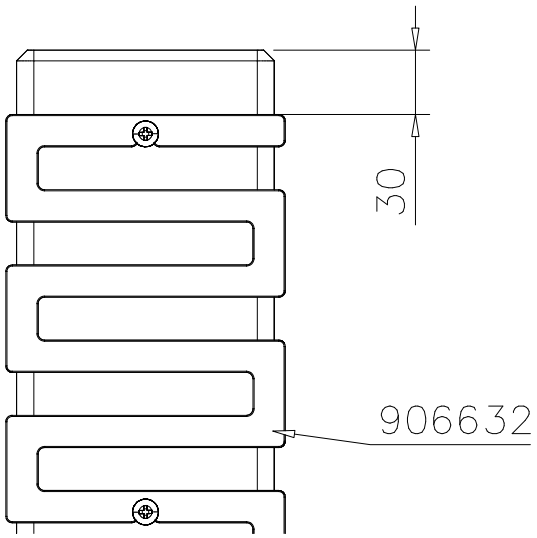

DET 56

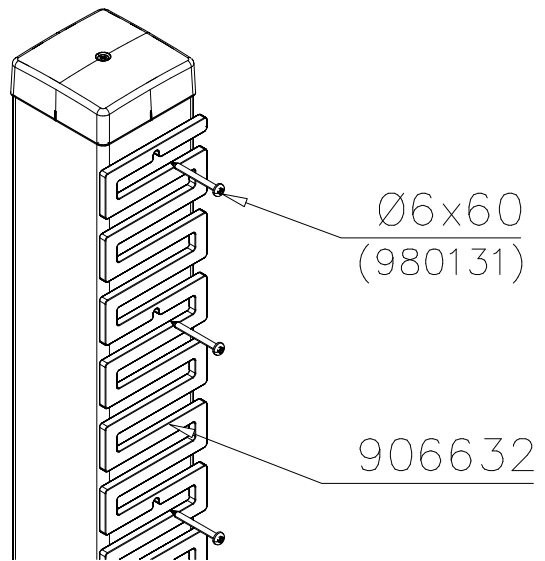

DET 57

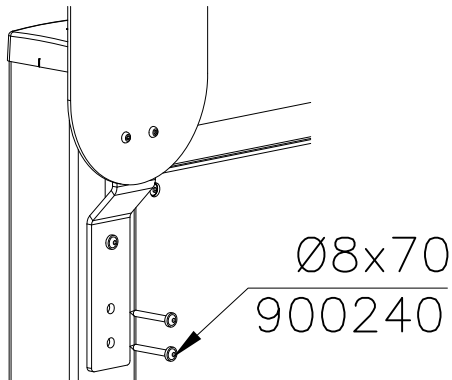

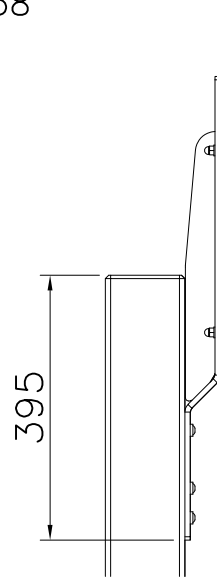

DET 58

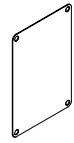

DET 59

DET 60

① SHEET METAL	PCS	② 980114	PCS
	1		4
118x78x0.7		Ø4x20	

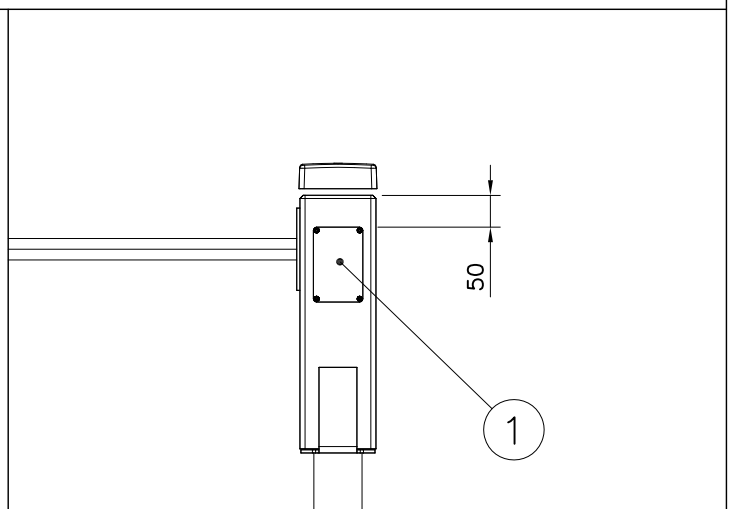
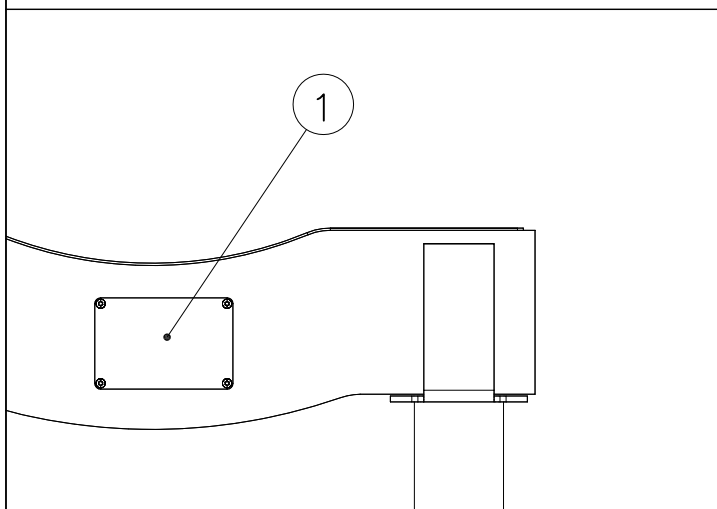
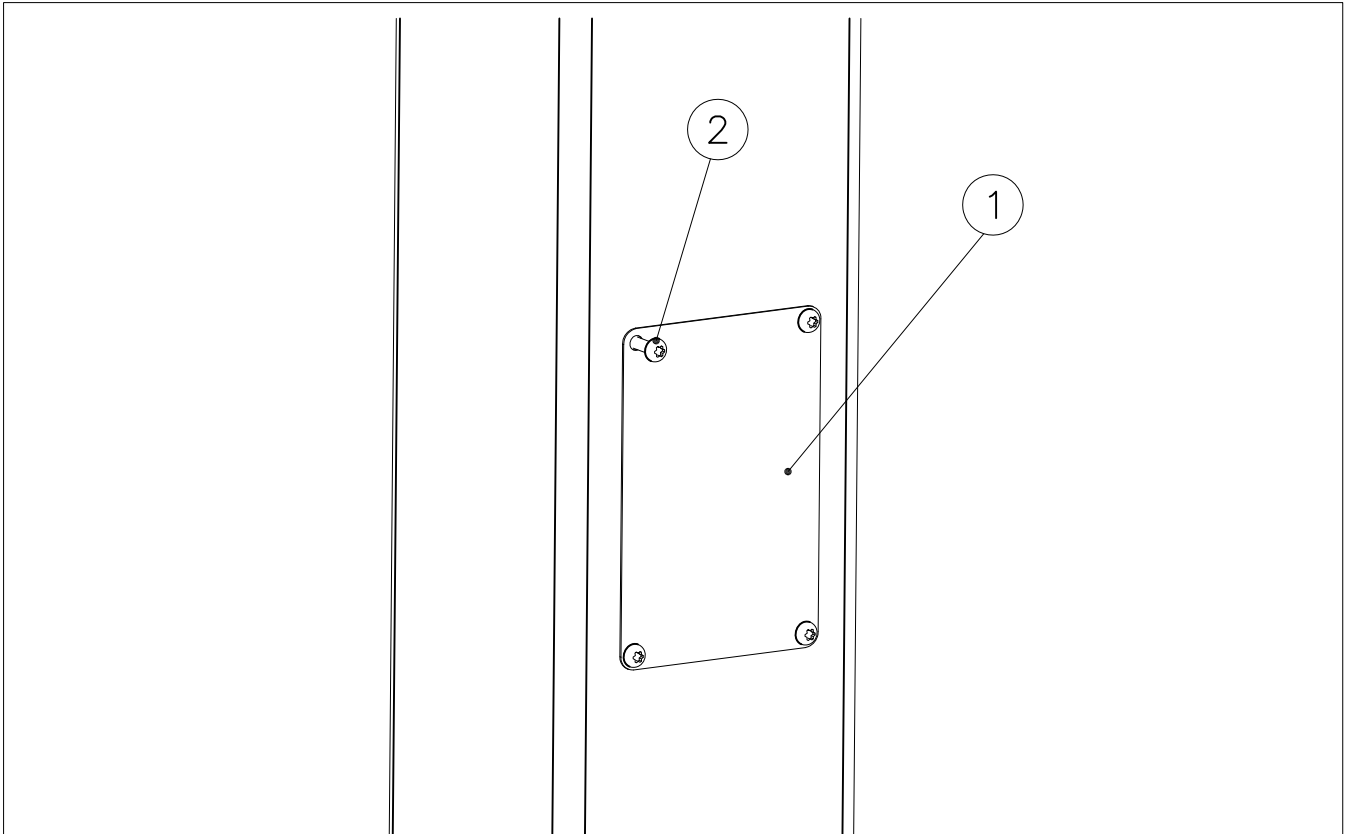

Example installation !
Esimerkki asennus !

Example installation !
Esimerkki asennus !

Example installation !
Esimerkki asennus !

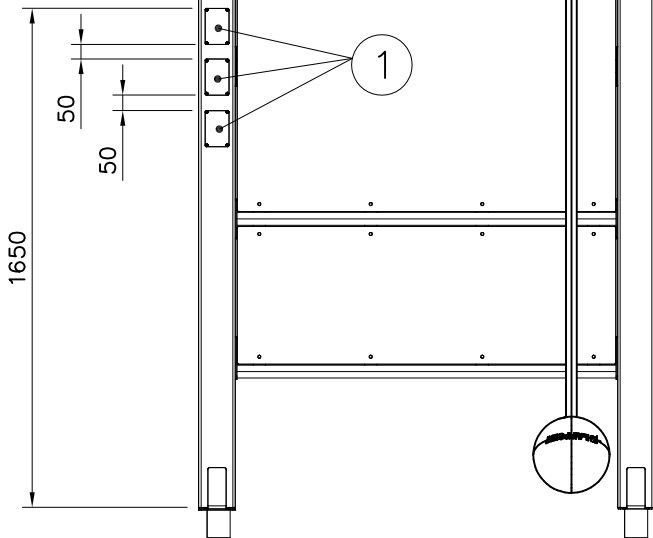

Example installation !
Esimerkki asennus !

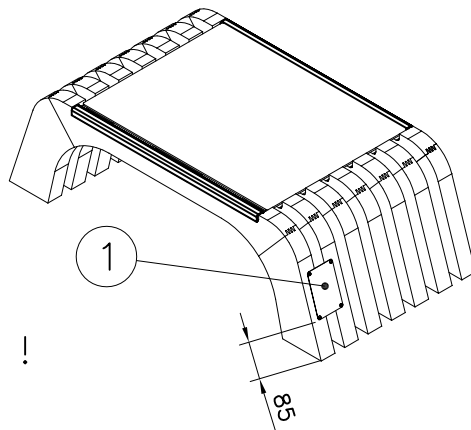
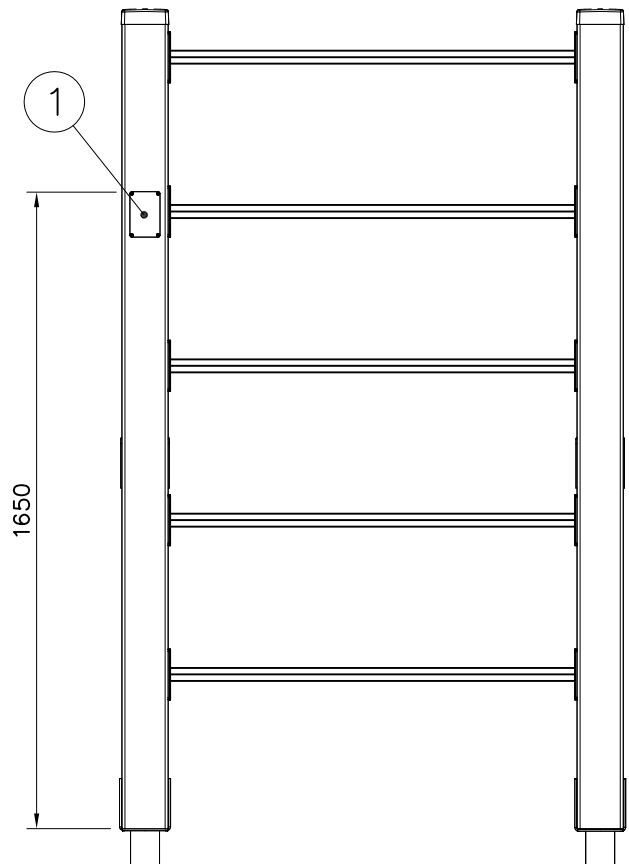

Example installation !
Esimerkki asennus !

LAPPSET®
BETON FOUNDATION

FOOT

DATE: 27.10.2015

1(1)

② 905104	PCS		PCS
	4		
 M10	PCS		PCS



905104