









-  Sillat
1
-  Kiipeilyt
2
-  Katot
1
-  Liu'ut
1
-  Tornit
2

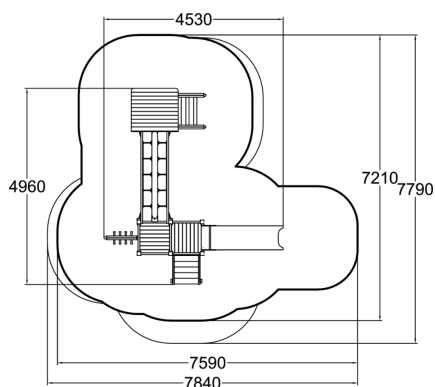
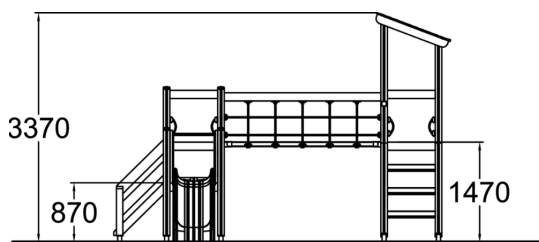

Ikäryhmä	1+
Käyttäjien määrä	9
Tuotteen pituus, mm	4530
Tuotteen leveys, mm	4960
Tuotteen korkeus, mm	3370
Turva-alue, m ²	37.4
Putoamistila, m ²	40.8
Tilantarve korkeus, mm	3370
Max.putoamiskorkeus, mm	1470
Turvallisuustiedot	EN 1176-1, 3 TÜV
Asennusaika (1 hlö), h	11
Perustusvaihtoehdot	deep_mounting
Puuosat	
Metalliosat	
Seinien ja HPL osien väri	
Köydet	