

RUBEN LITTER BIN

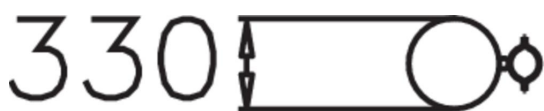

Litter bin with lid. Reuben is a litter bin made from 3 mm powder-coated steel, and has a tight-fitting lid. The bin has a volume of 35 litres and can either have poured foundations with a central post (40 mm) (NF2465), or be fixed to the wall (NF2466) or fitted on an existing post (105-120 mm).



Product length, mm	490
Product width, mm	325
Product height, mm	460
Foundation options	mounting_on_existing_post
Metal	