

This equipment provides gentle training for the core and leg muscles and our sense of balance. It consists of a swinging round base and a curved bar for holding on to. The total height is 1,460 mm, and the base is at 276 mm. Swinging provides a good alternative to the pumping motion that is common to most gym equipment. Hip can be installed on loose fill material also.

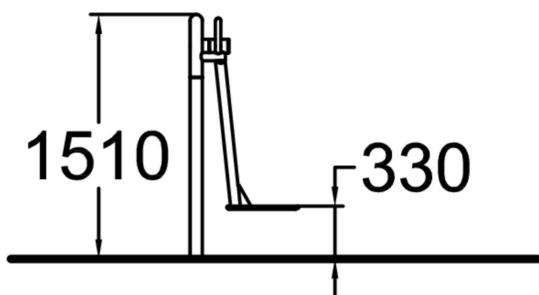
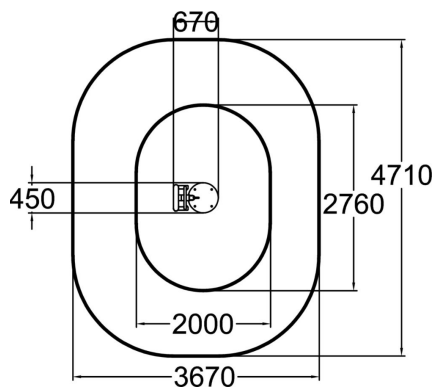

Number of users	1
Product length, mm	830
Product width, mm	500
Product height, mm	1510
Height required, mm	2090
Max. free fall height, mm	590
Safety info	EN 16630 TÜV
Foundation options	Surface mounting